

ÉCROU / NUT

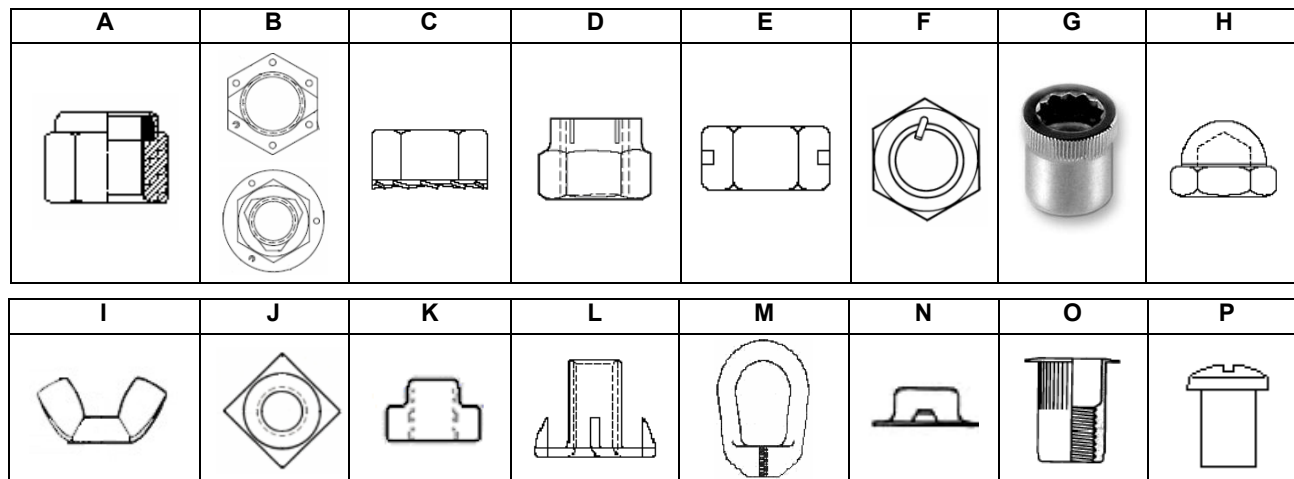

	Description		Page
A	Écrou à collet de nylon	Locknut Nylon Insert	451-459
A	Écrou à collet de nylon format large mince	Locknut Nylon Insert Heavy Thin	451-459
A	Écrou à collet de nylon format mince	Locknut Nylon Insert Thin	451-459
A	Écrou à collet de nylon métrique	Locknut Nylon Insert Metric	M121-M122
B	Écrou Stover	Locknut Stover	460-462
B	Écrou de blocage métrique STOVER	Locknut STOVER Metric	M120
C	Écrou Keps	Nut Keps	463
C	Écrou KEPS métrique	Nut KEPS Metric	M-123
D	Écrou Flexloc	Nut Flexloc	464
E	Écrou de blocage à deux sens	Nut Two-Way Reversible Lock	465
F	Écrou Anco	Locknut Anco	466
G	Écrou Allen	Nut Allen	468
H	Écrou borgne	Nut Acorn (Cap)	469-470
H	Écrou borgne métrique	Nut Acorn (Cap) Metric	M-127
I	Écrou à oreilles	Nut Wing	471-472
I	Écrou à oreilles métrique	Nut Wing Metric	M-126
J	Écrou carré	Nut Square	473-474
J	Écrou carré métrique	Nut Square Metric	M-125
K	Écrou en "T" rainuré	Nut T - Slot	475
L	Écrou en "T"	Nut T	476
M	Écrou à œil	Nut Eye	477
N	Écrou PAL	Nut PAL	478
O	Écrou-Rivet	Rivnut	479-480
P	Manchon fileté et relieur	Nut Sleeve and Binder Post	481

Écrou à collet de nylon Nylon Insert Locknut

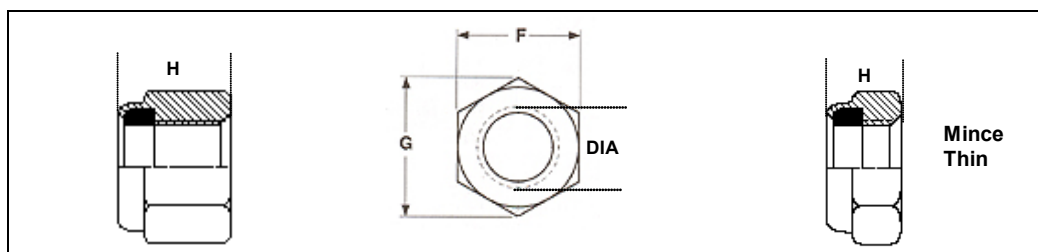

DIA		2-56	2-64	3-48	4-40	4-48	5-40
Acier zingué Steel Zinc Plated		0108 0002	0109 0002	0108 0003	0108 0004	0109 0004	0108 0005
Acier zingué jaune Yellow Zinc Plated							
Acier zingué noir Black Zinc Plated							
Grade 5							
Grade 8	Acier nu Plain Steel						
Grade 8	Zingué jaune Yellow Zinc						
Acier inoxydable 18-8 Stainless Steel 18-8		5042 0093			5042 0109		
Acier inoxydable 316 Stainless Steel 316							
Laiton Brass							
Format mince zingué Thin Zinc Plated NTM		0188 0002		0188 0003	0188 0004	0189 0004	0188 0005
Format mince acier inoxydable Thin Stainless Steel							
Format large zingué Heavy Zinc Plated NU							
Format large mince Heavy Thin Zinc Plated NTU							
Format à bride zingué jaune Flange Yellow Zinc							

Régulier/Regular				
F	.250	.250	.250	.250
H	.141	.141	.141	.141
Format mince/Thin Type				
F	.250	.250	.250	.250
H			.109	
Format large/Heavy Type				
F				
H				

Écrou à collet de nylon Nylon Insert Locknut

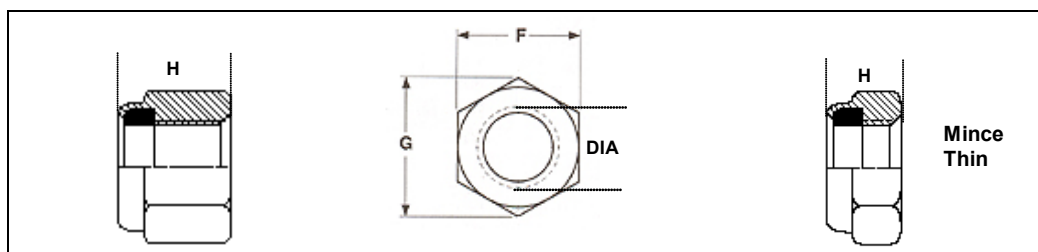

DIA		5-44	6-32	6-40	8-32	8-36	10-24
Acier zingué Steel Zinc Plated		0109 0005	0108 0006	0109 0006	0108 0008	0109 0008	0108 0010
Acier zingué jaune Yellow Zinc Plated					0632 0015*		
Acier zingué noir Black Zinc Plated							
Grade 5							
Grade 8	Acier nu Plain Steel						
Grade 8	Zingué jaune Yellow Zinc						
Acier inoxydable 18-8 Stainless Steel 18-8			5042 0140		5042 0152		5042 0187
Acier inoxydable 316 Stainless Steel 316							
Laiton Brass							
Format mince zingué Thin Zinc Plated NTM		0189 0005	0188 0006	0189 0006	0188 0008	0189 0008	0188 0010
Format mince acier inoxydable Thin Stainless Steel							
Format large zingué Heavy Zinc Plated NU							
Format large mince Heavy Thin Zinc Plated NTU							
Format à bride zingué jaune Flange Yellow Zinc					0633 0015		

Régulier/Regular				
F	.250	.316	.344	.375
H	.141	.172	.234	.234
Format mince/Thin Type				
F	.250	.316	.344	.375
H		.125	.172	.172
Format large/Heavy Type				
F				
H				

* à bride/Flange (0633 0015)

Écrou à collet de nylon Nylon Insert Locknut

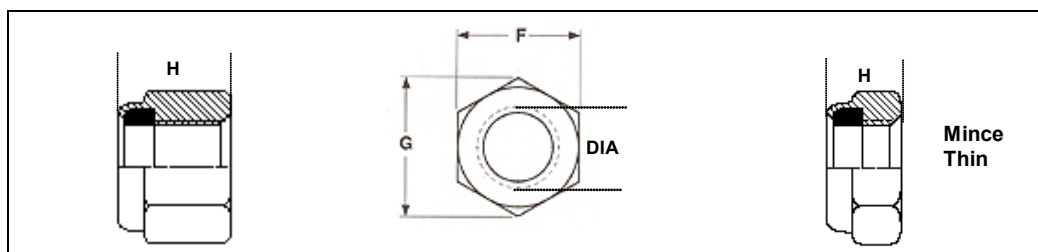

DIA		10-32	12-24	1/4-20	1/4-28	5/16-18	5/16-24
Acier zingué Steel Zinc Plated		0109 0010	0108 0012	0108 0025	0109 0025	0108 0031	0109 0031
Acier zingué jaune Yellow Zinc Plated				0632 0025			
Acier zingué noir Black Zinc Plated				0401 0025		0401 0031	
Grade 5				0634 0025			0635 0031
Grade 8	Acier nu Plain Steel			0192 0025	0193 0025	0192 0031	0193 0031
Grade 8	Zingué jaune Yellow Zinc			0237 0025	0238 0025	0237 0031	0238 0031
Acier inoxydable 18-8 Stainless Steel 18-8		5042 0188		5042 0250	5042 0251	5042 0312	5042 0313
Acier inoxydable 316 Stainless Steel 316				5089 0025	5089 0026	5089 0031	
Laiton Brass							
Format mince zingué Thin Zinc Plated	NTM	0189 0010	0188 0012*	0188 0025	0189 0025	0188 0031**	0189 0031
Format mince acier inoxydable Thin Stainless Steel				0479 0250		0479 0031	
Format large zingué Heavy Zinc Plated				0190 0025		0190 0031	
Format large mince Heavy Thin Zinc Plated				0191 0025		0191 0031	
Format à bride zingué jaune Flange Yellow Zinc							

Régulier/Regular						
F	.375	.438	.438		.500	
H	.234	.313	.313		.344	
Force/Strenght LBS			5 700	6 000	9 000	9 500
Format mince/Thin Type						
F	.375	.438	.438		.500	
H	.172		.203		.250	
Format large/Heavy Type						
F			.500		.563	
H			.375		.438	
H large mince/Heavy thin			.281		.313	

* 12/28 UNF (0189 0012)

** Zinc noir/black Zinc (0405 0031)

Écrou à collet de nylon Nylon Insert Locknut

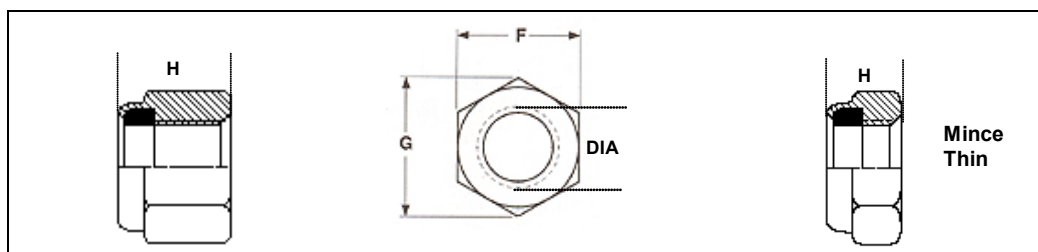

DIA		3/8-16	3/8-24	7/16-14	7/16-20	1/2-13	1/2-20
Acier zingué Steel Zinc Plated		0108 0038	0109 0038	0108 0043	0109 0043	0108 0050	0109 0050
Acier zingué jaune Yellow Zinc Plated						0632 0050	
Acier zingué noir Black Zinc Plated							
Grade 5		0634 0037	0635 0037				
Grade 8	Acier nu Plain Steel	0192 0038	0193 0038	0192 0043	0193 0043	0192 0050	0193 0050
Grade 8	Zingué jaune Yellow Zinc	0237 0038	0238 0038	0237 0043	0238 0043	0237 0050	0238 0050
Acier inoxydable 18-8 Stainless Steel 18-8		5042 0375	5042 0376	5042 0437	5042 0438	5042 0500	5042 0501
Acier inoxydable 316 Stainless Steel 316		5089 0037				5089 0050	
Laiton Brass		0568 0037				0568 0050	
Format mince zingué Thin Zinc Plated NTM		0188 0038	0189 0038	0188 0043	0189 0043	0188 0050	0189 0050
Format mince acier inoxydable Thin Stainless Steel		0479 0375					
Format large zingué Heavy Zinc Plated NU		0190 0038		0190 0043		0190 0050	
Format large mince Heavy Thin Zinc Plated NTU		0191 0037		0191 0043		0191 0050	
Format à bride zingué jaune Flange Yellow Zinc							

Régulier/Regular						
F	.563		.625		.750	
H	.453		.453		.594	
Force/Strenght LBS	14 000	15 500	18 000	19 600	25 000	26 700
Format mince/Thin Type						
F	.563		.625		.750	
H	.266		.313		.313	
Format large/Heavy Type						
F	.687		.750		.875	
H	.547		.593		.703	
H large mince/Heavy thin	.406		.437		.531	

Écrou à collet de nylon Nylon Insert Locknut

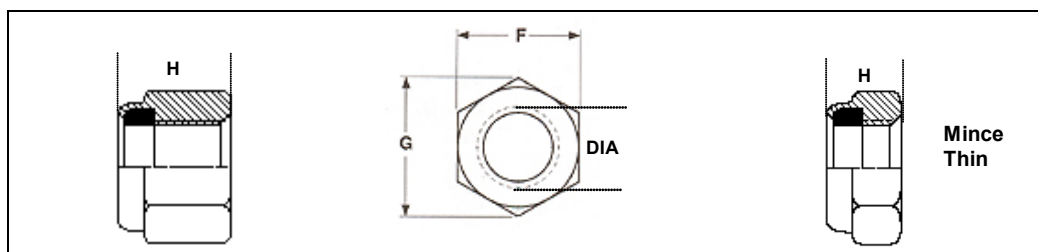

DIA		9/16-12	9/16-18	5/8-11	5/8-18	3/4-10	3/4-16
Acier zingué Steel Zinc Plated		0108 0056	0109 0056	0108 0062	0109 0062	0108 0075	0109 0075
Acier zingué jaune Yellow Zinc Plated							
Acier zingué noir Black Zinc Plated							
Grade 5		0634 0056				0634 0075	
Grade 8	Acier nu Plain Steel	0192 0056	0193 0056	0192 0062	0193 0062	0192 0075	0193 0075
Grade 8	Zingué jaune Yellow Zinc	0237 0056	0238 0056	0237 0062	0238 0062	0237 0075	0238 0075
Acier inoxydable 18-8 Stainless Steel 18-8		5042 0562		5042 0625	5042 0626	5042 0750	5042 0751
Acier inoxydable 316 Stainless Steel 316				5089 0062		5089 0075	
Laiton Brass							
Format mince zingué Thin Zinc Plated NTM		0188 0056	0189 0056	0188 0062	0189 0062	0188 0075	0189 0075
Format mince acier inoxydable Thin Stainless Steel							
Format large zingué Heavy Zinc Plated NU		0190 0056	0890 0056	0190 0062		0190 0075	
Format large mince Heavy Thin Zinc Plated NTU		0191 0056		0191 0062	0191 0063	0191 0075	0191 0076
Format à bride zingué jaune Flange Yellow Zinc							

Régulier/Regular						
F	.875		.938		1.063	
H	.640		.750		.875	
Force/Strenght LBS	32 000	34 000	42 000	45 700	50 500	56 000
Format mince/Thin Type						
F			.938		1.063	
H			.391		.406	
Format large/Heavy Type						
F			1.060		1.125	
H			.850		1.000	
H large mince/Heavy thin			.609		.703	

Écrou à collet de nylon Nylon Insert Locknut

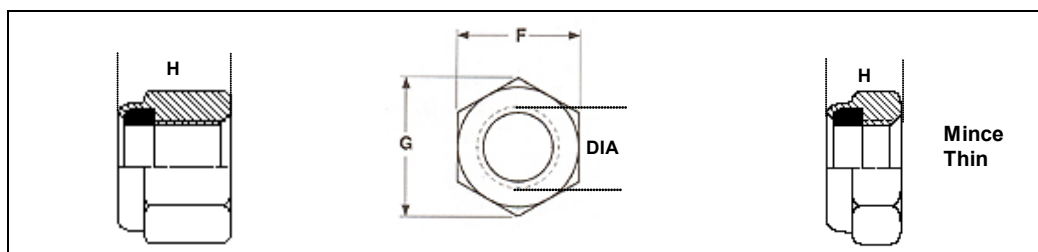

DIA		7/8-9	7/8-14	1-8	1-14	1-1/8(7)	1-1/8(12)
Acier zingué Steel Zinc Plated		0108 0087	0109 0087	0108 0100	0109 0100	0108 0112	0109 0112
Acier zingué jaune Yellow Zinc Plated							
Acier zingué noir Black Zinc Plated							
Grade 5		0634 0087				0634 0112	
Grade 8	Acier nu Plain Steel	0192 0087	0193 0087	0192 0100	0193 0100	0192 0112	0193 0112
Grade 8	Zingué jaune Yellow Zinc	0237 0087	0238 0087	0237 0100	0238 0100		
Acier inoxydable 18-8 Stainless Steel 18-8		5042 0875	5042 0876	5042 1000			
Acier inoxydable 316 Stainless Steel 316		5089 0087		5089 0100			
Laiton Brass							
Format mince zingué Thin Zinc Plated NTM		0188 0087	0189 0087	0188 0100	0189 0100	0188 0112	0189 0112
Format mince acier inoxydable Thin Stainless Steel							
Format large zingué Heavy Zinc Plated NU		0190 0087		0190 0100		0190 0112	
Format large mince Heavy Thin Zinc Plated NTU		0191 0087*		0191 0100		0191 0112	
Format à bride zingué jaune Flange Yellow Zinc							

Régulier/Regular			
F	1.125	1.440	1.625
H	.984	1.047	1.187
Force/Strength LBS	69 300	76 400	90 900
Format mince/Thin Type			
F	1.125	1.440	1.625
H	.468	.562	.656
Format large/Heavy Type			
F	1.440	1.627	1.814
H	1.125	1.296	1.438
H large mince/Heavy thin	.781	.906	

* Grade 8 (0191 0875)

Écrou à collet de nylon Nylon Insert Locknut

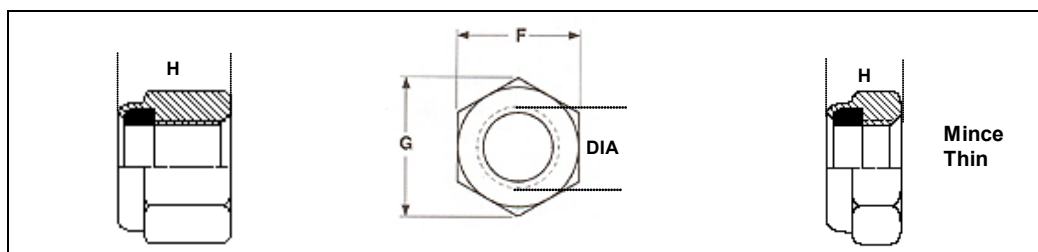

DIA		1-1/4(7)	1-1/4(12)	1-3/8(6)	1-3/8(12)	1-1/2(6)	1-1/2(12)
Acier zingué Steel Zinc Plated		0108 0125	0109 0125	0108 0137	0109 0137	0108 0150	0109 0150
Acier zingué jaune Yellow Zinc Plated							
Acier zingué noir Black Zinc Plated							
Grade 5		0634 0125		0634 0137			
Grade 8	Acier nu Plain Steel	0192 0125	0193 0125	0192 0137		0192 0150	0193 0150
Grade 8	Zingué jaune Yellow Zinc	0237 0125					0238 0150
Acier inoxydable 18-8 Stainless Steel 18-8							
Acier inoxydable 316 Stainless Steel 316							
Laiton Brass							
Format mince zingué Thin Zinc Plated		0188 0125	0189 0125	0188 0137	0189 0137	0188 0150	0189 0150
Format mince acier inoxydable Thin Stainless Steel							
Format large zingué Heavy Zinc Plated		0190 0125		0190 0137		0190 0150	
Format large mince Heavy Thin Zinc Plated		0191 0125		0191 0137		0191 0150	
Format à bride zingué jaune Flange Yellow Zinc							

Régulier/Regular			
F	1.810		2.197
H	1.406		1.625
Force/Strengh LBS			
Format mince/Thin Type			
F	1.810		2.197
H	.750		.812
Format large/Heavy Type			
F	2.000		2.380
H	1.625		1.906
H large mince/Heavy thin	1.093		1.296

Écrou à collet de nylon Nylon Insert Locknut

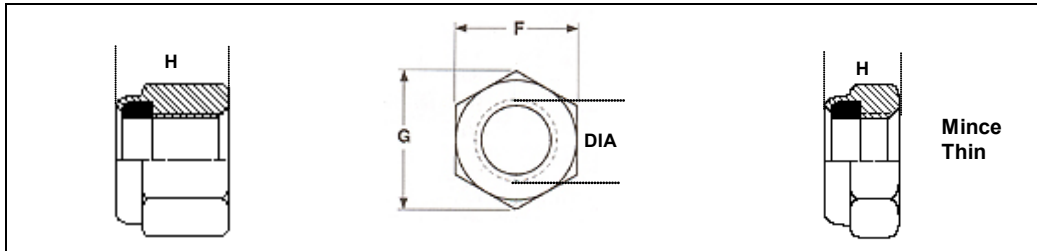

DIA		1-3/4(5)	1-3/4(12)	2(4-1/2)	2(12)	2-1/4(4-1/2)	2-1/4(12)
Acier zingué Steel Zinc Plated		0108 0175	0109 0175	0108 0200	0109 0200	0108 0225	0109 0225
Acier zingué jaune Yellow Zinc Plated							
Acier zingué noir Black Zinc Plated							
Grade 5			0410 0175				
Grade 8	Acier nu Plain Steel	0192 0175	0193 0175	0192 0200	0193 0200		
Grade 8	Zingué jaune Yellow Zinc						
Acier inoxydable 18-8 Stainless Steel 18-8							
Acier inoxydable 316 Stainless Steel 316							
Laiton Brass							
Format mince zingué Thin Zinc Plated NTM							
Format mince acier inoxydable Thin Stainless Steel							
Format large zingué Heavy Zinc Plated NU		0190 0175		0190 0200			
Format large mince Heavy Thin Zinc Plated NTU		0191 0175	0191 0176	0191 0200			0191 0226
Format à bride zingué jaune Flange Yellow Zinc							

Régulier/Regular			
F			
H			
Format mince/Thin Type			
F			
H			
Format large/Heavy Type			
F			
H			
H large mince/Heavy thin			

Écrou à collet de nylon Nylon Insert Locknut

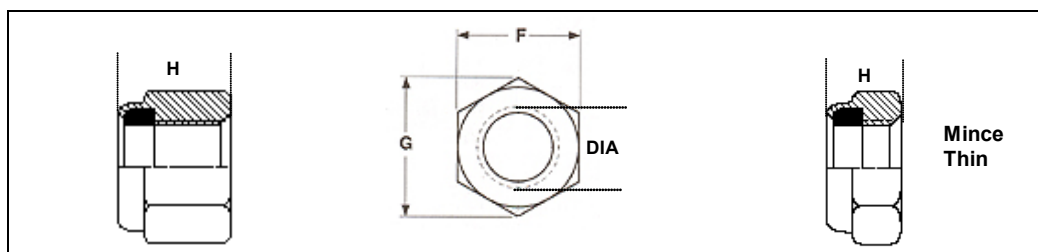

DIA		2-1/2(4)	2-1/2(12)	3	3(12)		
Acier zingué Steel Zinc Plated		0108 0250	0109 0250				
Acier zingué jaune Yellow Zinc Plated							
Acier zingué noir Black Zinc Plated							
Grade 5							
Grade 8	Acier nu Plain Steel				0193 0300		
Grade 8	Zingué jaune Yellow Zinc						
Acier inoxydable 18-8 Stainless Steel 18-8							
Acier inoxydable 316 Stainless Steel 316							
Laiton Brass							
Format mince zingué Thin Zinc Plated NTM							
Format mince acier inoxydable Thin Stainless Steel							
Format large zingué Heavy Zinc Plated NU							
Format large mince Heavy Thin Zinc Plated NTU							
Format à bride zingué jaune Flange Yellow Zinc							

Régulier/Regular			
F			
H			
Format mince/Thin Type			
F			
H			
Format large/Heavy Type			
F			
H			
H large mince/Heavy thin			

Écrou Stover Stover Locknut

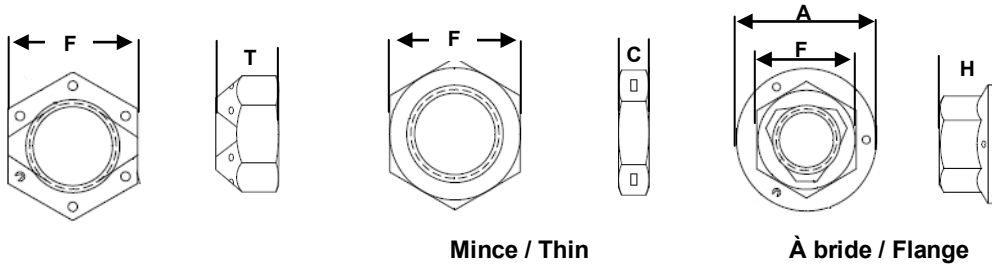

DIA		8-32	1/4-20	1/4-28	5/16-18	5/16-24
Acier plaqué & ciré Steel Zinc Plated & Wax	Grade B		0386 0025	0387 0025	0386 0031	0387 0031
	Grade C		0388 0025	0389 0025	0388 0031	0389 0031
	Collet mince Thin Collar Grade C					
Acier inoxydable Stainless Steel	316		5092 0025		5092 0031	
Acier plaqué zinc jaune Steel Yellow Zinc Plated	L9		0099 0025	0100 0025	0099 0031	0100 0031
Acier plaqué & ciré à bride Flange Steel Zinc Plated & Wax	Grade G	0392 0152	0392 0025			0393 0031
	A		.560	.560	.680	.680
	C		.163	.163	.195	.195
	F		7/16	7/16	1/2	1/2
	H		.300	.300	.365	.365
	T		.288	.288	.336	.336

DIA		3/8-16	3/8-24	7/16-14	7/16-20	1/2-13	1/2-20
Acier plaqué & ciré Steel Zinc Plated & Wax	Grade B	0386 0037	0387 0037	0386 0043	0387 0043	0386 0050	0387 0050
	Grade C	0388 0037	0389 0037	0388 0043	0389 0043	0388 0050	0389 0050
	Collet mince Thin Collar Grade C	0390 0037	0391 0037	0390 0043	0391 0043	0390 0050	0391 0050
Acier inoxydable Stainless Steel	316	5092 0037				5092 0050	
Acier plaqué zinc jaune Steel Yellow Zinc Plated	L9	0099 0038	0100 0038	0099 0043	0100 0043	0099 0050	0100 0050
Acier plaqué & ciré à bride Flange Steel Zinc Plated & Wax	Grade G	0392 0037	0393 0037	0392 0043	0393 0043	0392 0050	0393 0050
	A	.810	.810	.930	.930	1.070	1.070
	C	.227	.227	.260	.260	.323	.323
	F	9/16	9/16	11/16	11/16	3/4	3/4
	H	.425	.425	.495	.495	.555	.555
	T	.415	.415	.463	.463	.573	.573

Écrou Stover Stover Locknut

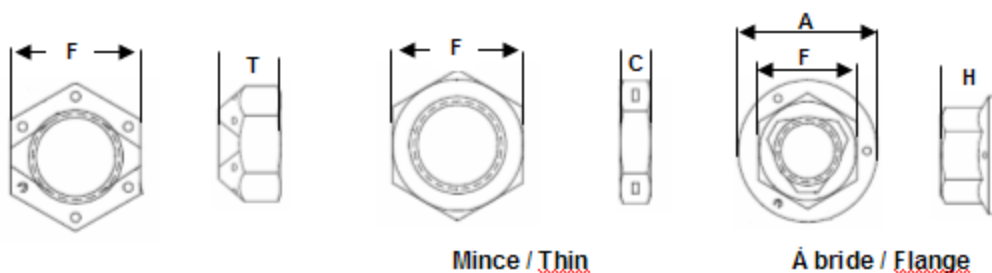

DIA		9/16-12	9/16-18	5/8-11	5/8-18	3/4-10	3/4-16
Acier plaqué & ciré Steel Zinc Plated & Wax	Grade B	0386 0056	0387 0056	0386 0062	0387 0062	0386 0075	0387 0075
	Grade C	0388 0056	0389 0056	0388 0062	0389 0062	0388 0075	0389 0075
	Collet mince Thin Collar Grade C	0390 0056	0391 0056	0390 0062	0391 0062	0390 0075	0391 0075
Acier inoxydable Stainless Steel	316			5092 0062		5092 0075	
Acier plaqué zinc jaune Steel Yellow Zinc Plated	L9	0099 0056	0100 0056	0099 0062	0100 0062	0099 0075	0100 0075
Acier plaqué & ciré à bride Flange Steel Zinc Plated & Wax	Grade G			0392 0062	0393 0062	0392 0075	
	A	1.190	1.190	1.330	1.330	1.585	1.585
	C	.324	.324	.387	.387	.446	.446
	F	7/8	7/8	15/16	15/16	1-1/8	1-1/8
	H	.625	.625	.690	.690	.825	.825
	T	.621	.621	.731	.731	.827	.827

DIA		7/8-9	7/8-14	1-8	1-14	1-1/8(7)	1-1/8(12)
Acier plaqué & ciré Steel Zinc Plated & Wax	Grade B	0386 0087	0387 0087	0386 0100	0387 0100		
	Grade C	0388 0087	0389 0087	0388 0100	0389 0100	0388 0112	0389 0112
	Collet mince Thin Collar Grade C						
Acier inoxydable Stainless Steel	316						
Acier plaqué zinc jaune Steel Yellow Zinc Plated	L9	0099 0087	0100 0087	0099 0100	0100 0100	0099 0112	0100 0112
Acier plaqué & ciré à bride Flange Steel Zinc Plated & Wax	Grade G		0393 0087				
	A						
	C	.510	.510	.575	.575		
	F	1-5/16	1-5/16	1-1/2	1-1/2	1-11/16	1-11/16
	H						
	T	.922	.922	1.018	1.018		

Écrou Stover Stover Locknut

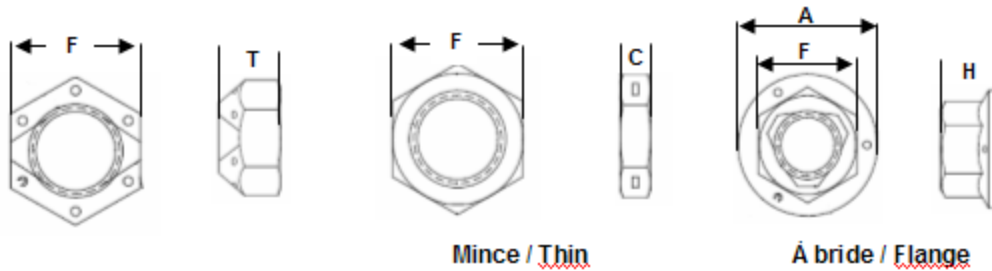

DIA		1-1/4(7)	1-1/4(12)	1-3/8(6)	1-3/8(12)	1-1/2(6)	1-1/2(12)
Acier plaqué & ciré Steel Zinc Plated & Wax	Grade B						
	Grade C	0388 0125	0389 0125	0388 0137	0389 0137	0388 0150	0389 0150
	Collet mince Thin Collar Grade C						
Acier inoxydable Stainless Steel	316						
Acier plaqué zinc jaune Steel Yellow Zinc Plated	L9	0099 0125	0100 0125			0099 0150	0100 0150
Acier plaqué & ciré à bride Flange Steel Zinc Plated & Wax	Grade G						
	A						
	C						
	F	1-7/8	1-7/8			2-1/4	2-1/4
	H						
	T						

DIA		1-3/4(5)	1-3/4(12)				
Acier plaqué & ciré Steel Zinc Plated & Wax	Grade B						
	Grade C						
	Collet mince Thin Collar Grade C						
Acier inoxydable Stainless Steel	316						
Acier plaqué zinc jaune Steel Yellow Zinc Plated	L9						
Acier plaqué & ciré à bride Flange Steel Zinc Plated & Wax	Grade G						
	A						
	C						
	F	2-5/8	2-5/8				
	H						
	T						

Écrou Keps Keps Nut

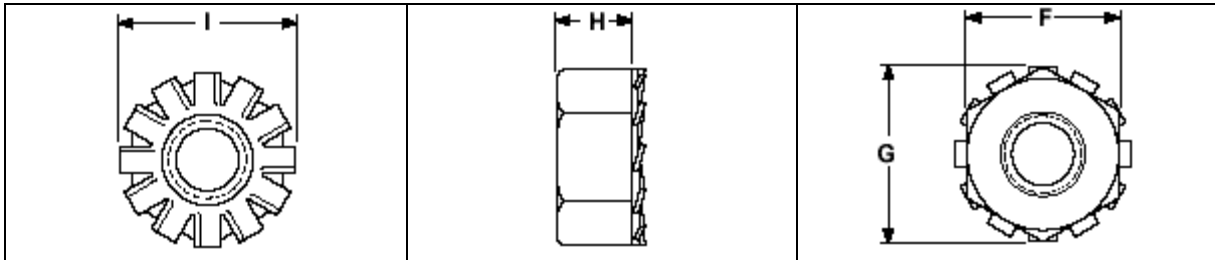

DIA	Acier Zingué Steel Zinc Plated	Acier inoxydable Stainless Steel 18-8	F	G	H	I
4-40	0119 0004	5040 0109	1/4	.289/.275	.098/.087	.286/.277
6-32	0119 0006	5040 0140	5/16	.361/.344	.114/.102	.348/.338
8-32	0119 0008	5040 0152	11/32	.397/.378	.130/.117	.381/.370
10-24	0119 0010	5040 0187	3/8	.433/.413	.130/.117	.406/.395
10-32	0119 0011	5040 0188	3/8	.433/.413	.130/.117	.406/.395
1/4-20	0119 0025	5040 0250	7/16	.505/.482	.193/.178	.506/.494
5/16-18	0119 0031	5040 0312	1/2	.577/.557	.273/.258	.592/.579
3/8-16	0119 0038	5040 0375	9/16	.650/.628	.385/.365	.665/.651

Écrou Flexloc Flexloc Nut

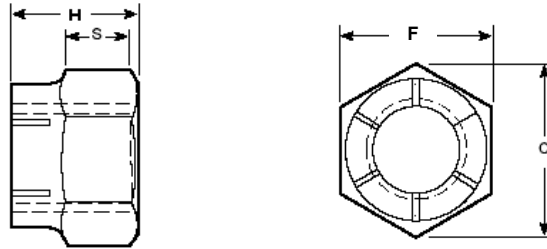

DIA	Acier Steel	F	G	H	S
8-32	0381 20FA832				
8-36	0381 21FA836				
10-24	0381 21FA1024				
10-32	0381 21FA1032				
1/4-20	0381 21FA420	.502/.492	.552	.290	.094
5/16-18	0381 21FAF518	.564/.553	.622	.321	.113
3/8-16	0381 21FAF616	.627/.616	.696	.384	.144
7/16-14		.752/.741	.837	.446	.163
1/2-13	0381 20FA313	.814/.803	.907	.509	.196
9/16-12		.940/.928	1.051	.571	.216
5/8-11	0381 30FA1011	1.002/.990	1.119	.634	.245
3/4-10		1.127/1.115	1.260	.759	.325
7/8-9		1.314/1.301	1.470	.884	.397
1-8		1.502/1.489	1.682	1.009	.462
1-1/8(7)		1.814/1.801	2.038	1.134	.549
1-1/4(7)		2.002/1.988	2.225	1.259	.616
1-3/8(6)		2.190/2.176	2.484	1.384	.684
1-1/2(6)		2.377/2.363	2.697	1.509	.748
1-5/8(5-1/2)		2.564/2.549	2.909	1.634	.814
1-3/4(5)		2.752/2.737	3.124	1.759	.882
1-7/8(5)		2.940/2.925	3.338	1.884	.950
2(4-1/2)		3.127/3.112	3.552	2.009	1.018

Écrou de blocage à deux sens Two-Way Reversible Lock Nut

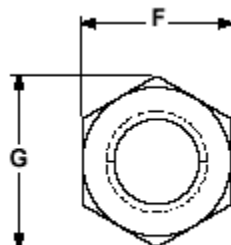
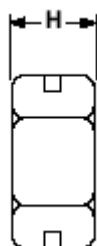

DIA	Acier nu Plain Steel	Acier inoxydable Stainless Steel	F	G	H
1/4-20			7/16	1/2	7/32
1/4-28			7/16	1/2	7/32
5/16-18			1/2	9/16	17/64
5/16-24			1/2	9/16	17/64
3/8-16	0681 0037		9/16	41/64	21/64
3/8-24			9/16	41/64	21/64
7/16-14			11/16	25/32	3/8
7/16-20			11/16	25/32	3/8
1/2-13			3/4	27/32	7/16
1/2-20			3/4	27/32	7/16
9/16-12			7/8	1	31/64
9/16-18			7/8	1	31/64
5/8-11		0478 0625	15/16	1-1/16	35/64
5/8-18			15/16	1-1/16	35/64
3/4-10			1-1/8	1-9/32	41/64
3/4-16			1-1/8	1-9/32	41/64
7/8-9			1-5/16	1-31/64	3/4
7/8-14			1-5/16	1-31/64	3/4
1-8			1-1/2	1-11/64	55/64
1-14			1-1/2	1-11/64	55/64

Écrou Anco Anco Locknut

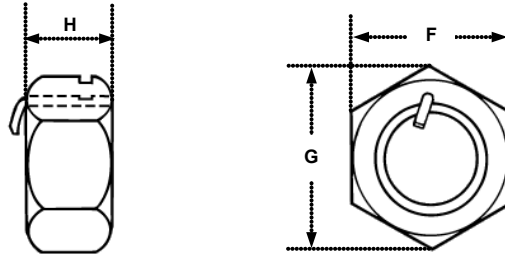

DIA	Acier Steel	F	G	H
5/8-11	0380 0062			
3/4-10	0380 0075			
7/8-9	0380 0087			
1-8	0380 0100			
1-1/8(8)	0380 0112			
1-1/4(8)	0380 0125			
1-1/2(8)	0380 0150			

Écrou Allen Allen Nut



DIA	Acier Steel			
4-40	0251 0004			
5-40	0251 0005			
6-32	0251 0006			
8-32	0251 0008			
10-24	0251 0010			
10-32	0251 0011			
1/4-20	0251 0025			
1/4-28	0251 0026			
5/16-18	0251 0031			
5/16-24	0251 0032			
3/8-16	0251 0037			
3/8-24	0251 0038			
7/16-14	0251 0043			
7/16-20	0251 0044			
1/2-13	0251 0050			
1/2-20	0251 0051			
5/8-11	0251 0062			
5/8-18	0251 0063			
3/4-10	0251 0075			
3/4-16	0251 0076			
7/8-9	0251 0087			
7/8-14	0251 0088			
1-8	0251 0100			
1-14	0251 0101			

Écrou borgne Acorn Nut (Cap)

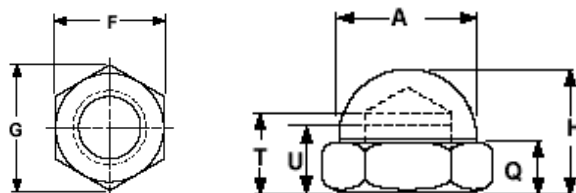

DIA		4-40	6-32	8-32	10-24	10-32
Acier nicklé Steel Nickel Plated			0104 0006	0104 0008	0104 0010	0104 0011
Acier inoxydable 18-8 Stainless Steel 18-8		5041 0109	5041 0140	5041 0152	5041 0187	5041 0188
Laiton Brass			0507 0140	0507 0152	0507 0187	0507 0188
Aluminium Aluminum						
Nylon (type 6/6)						
	A		.300	.300	.360	.360
	F		.302/.313	.302/.313	.362/.375	.362/.375
	G		.344/.361	.344/.361	.413/.433	.413/.433
	H		.340	.340	.410	.410
	Q		.160	.160	.190	.190
	U		.160	.160	.190	.190
	T		.250	.250	.280	.280

DIA		1/4-20	1/4-28	5/16-18	5/16-24	3/8-16	3/8-24
Acier nicklé Steel Nickel Plated		0104 0025		0104 0031		0104 0038	
Acier inoxydable 18-8 Stainless Steel 18-8		5041 0250	5041 0251	5041 0312	5041 0313	5041 0375	5041 0376
Laiton Brass		0507 0250		0507 0312		0507 0375	
Aluminium Aluminum							
Nylon (type 6/6)							
	A	.410	.410	.470	.470	.530	.530
	F	.428/.438	.428/.438	.489/.500	.489/.500	.551/.563	.551/.563
	G	.488/.505	.488/.505	.557/.577	.557/.577	.628/.650	.628/.650
	H	.470	.470	.530	.530	.620	.620
	Q	.220	.220	.250	.250	.280	.280
	U	.250	.250	.310	.310	.380	.380
	T	.340	.340	.410	.410	.450	.450

Écrou borgne Acorn Nut (Cap)

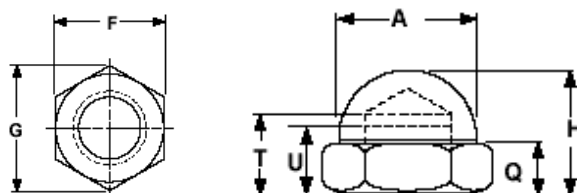

DIA	1/2-13	1/2-20	5/8-11		3/4-10	
Acier nicklé Steel Nickel Plated	0104 0050*		0104 0062		0104 0075	
Acier inoxydable 18-8 Stainless Steel 18-8	5041 0500	5041 0501	5041 0625		5041 0750	
Laiton Brass						
Aluminium Aluminum						
Nylon (type 6/6)						
	A	.72	.72	.91		1.03
	F	3/4	3/4	15/16		1-1/16
	G	.866/.840	.866/.840	1.083/1.051		1.227/1.191
	H	.81	.81	1.00		1.16
	Q	.38	.38	.47		.53
	U	.50	.50	.62		.75
	T	.59	.59	.75		.88

* H = XX/XX (0104 0500)

Écrou à oreilles Wing Nut

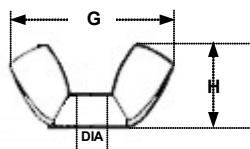

DIA	6-32	8-32	10-24	10-32	12-24	
Acier zingué Steel Zinc Plated	0103 0006*	0103 0008	0103 0010*	0103 0011	0103 0012	
Acier galvanisé Steel Galvanized						
Acier inoxydable 18-8 Stainless Steel 18-8	5039 0140	5039 0152	5039 0187	5039 0188		
Laiton Brass	0508 0140	0508 0152	0508 0187	0508 0188		
Nylon (type 6/6)						
	G	.91	.91	.91	.91	1.10
	H	.47	.47	.47	.47	.57

* Zinc noir / Black Zinc 10-24 (0400 0062)
1/4-20 (0400 0025)

DIA	1/4-20	1/4-28	5/16-18	5/16-24	3/8-16	3/8-24	
Acier zingué Steel Zinc Plated	0103 0025	0103 0026	0103 0031	0103 0032	0103 0038	0103 0039	
Acier galvanisé Steel Galvanized	0583 0250				0583 0375		
Acier inoxydable 18-8 Stainless Steel 18-8	5039 0250		5039 0312		5039 0375		
Laiton Brass	0508 0250	0508 0251	0508 0312		0508 0375		
Nylon (type 6/6)							
	G	1.10	1.10	1.25	1.25	1.44	1.44
	H	.57	.57	.66	.66	.79	.79

Écrou à oreilles Wing Nut

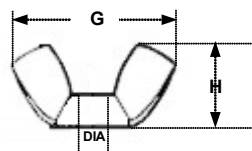

DIA	7/16-14	1/2-13		5/8-11		3/4-10
Acier zingué Steel Zinc Plated	0103 0043	0103 0050		0103 0062		0103 0075
Acier galvanisé Steel Galvanized	0583 0437	0583 0500				
Acier inoxydable 18-8 Stainless Steel 18-8	5039 0437	5039 0500		5039 0625		5039 0750
Laiton Brass		0508 0500		0508 0625		0508 0750
Nylon (type 6/6)						
	G	1.94	1.94		2.76	2.76
	H	1.00	1.00		1.44	1.44

Écrou carré Square Nut

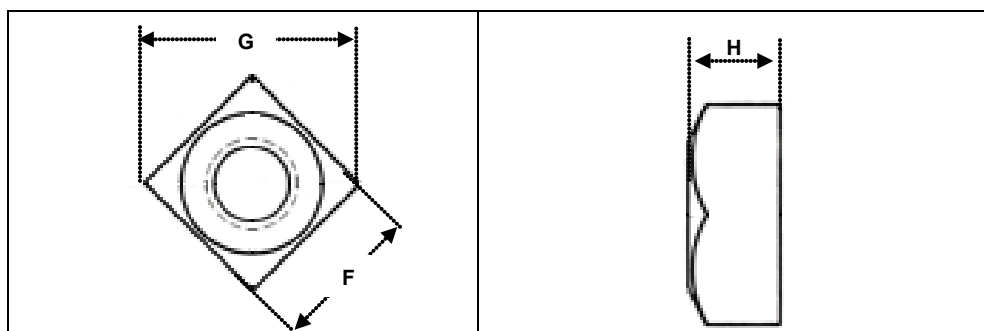

DIA		4-40	5-40	6-32	8-32	10-24	10-32	12-24
À vis mécanique zingué Machine Screw Zinc Plated		0185 0004	0185 0005	0185 0006	0185 0008	0185 0010	0185 0011	
Acier inoxydable Stainless Steel 18-8		5038 0109		5038 0140	5038 0152	5038 0187	5038 0188	
À vis mécanique Machine Screw	F	1/4	5/16	5/16	11/32	3/8	3/8	
	G	11/32	7/16	7/16	5/32	33/64	33/64	
	H	3/32	7/64	7/64	1/8	1/8	1/8	

DIA		1/4-20	5/16-18	3/8-16	7/16-14	1/2-13	9/16-12	5/8-11
À vis mécanique zingué Machine Screw Zinc Plated		0185 0025	0185 0031	0185 0038				
Régulier acier nu Regular Plain Steel		0114 0025	0114 0031	0114 0038	0114 0043	0114 0050	0114 0056	0114 0062
Régulier acier galvanisé Regular Galvanized Steel				0115 0038	0115 0043	0115 0050		0115 0062
Grade 5								
Grade 5 – Zinqué/Zinc Plated								
Grade 8								
Acier inoxydable Stainless Steel 18-8		5038 0250		5038 0375		5038 0500		5038 0625
Laiton/Brass				0569 0037				
Large acier nu Heavy Plain Steel								
Large acier zingué Heavy Steel Zinc Plated								
À vis mécanique Machine Screw	F	7/16	9/16	5/8				
	G	.619	.795	.884				
	H	.193	.225	.257				
Régulier Regular	F	7/16	9/16	5/8	3/4	13/16		1
	G							
	H	7/32	17/64	21/64	3/8	7/16		35/64
Large Heavy	F							
	G							
	H							

Écrou carré Square Nut

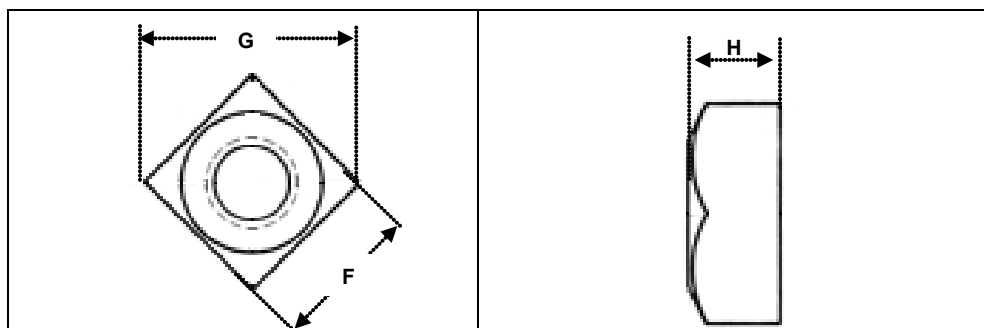

DIA	3/4-10	7/8-9	1-8	1-1/8(7)	1-1/4(7)	1-3/8(6)	1-1/2(6)	
Régulier acier nu Regular Plain Steel	0114 0075	0114 0087	0114 0100	0114 0112	0114 0125		0114 0150	
Régulier acier galvanisé Regular Galvanized Steel	0115 0075	0115 0087	0115 0100					
Grade 5			0576 1000					
Grade 5 – Zinqué/Zinc Plated	0577 0750							
Grade 8			0581 1000					
Acier inoxydable 18-8 Stainless Steel								
Laiton/Brass								
Large acier nu Heavy Plain Steel		0116 0087	0116 0100	0116 0112	0116 0125		0116 0150	
Large acier zingué Heavy Steel Zinc Plated		0579 0875						
Régulier Regular	F	1-1/8	1-5/16	1-1/2	1-11/16	1-7/8	2-1/16	2-1/4
	G	1-17/32	1-51/64	2-1/16	2-5/16	2-9/16	2-53/64	3-3/32
	H	21/32	49/64	7/8	1	1-3/32	1-13/64	1-5/16
Large Heavy	F	1-1/4	1-7/16	1-5/8	1-13/16	2	2-3/16	2-3/8
	G	1-23/32	1-31/32	2-15/64	2-1/2	2-3/4	3-1/32	3-9/32
	H	3/4	7/8	1	1-1/8	1-1/4	1-3/8	1-1/2

Écrou en "T" rainuré

T- Slot Nut

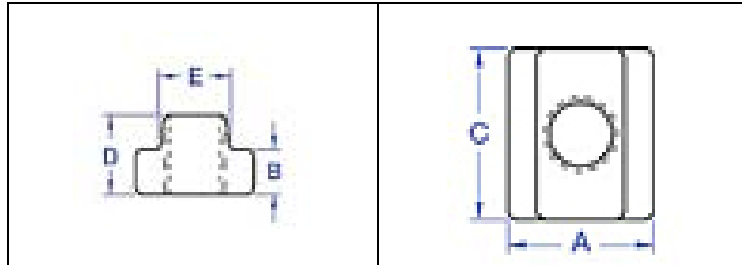

Filets Thread	Acier Steel	A	B	C	D	E
1/2-13	0399 1409	1-1/8	13/32	1-1/4	3/4	5/8
5/8-11	0399 1416	1-5/16	17/32	1-1/2	7/8	3/4
3/4-10		1-1/2	9/16	1-3/4	1	7/8
7/8-9		1-3/4	5/8	2	1-1/8	1
1-8		2	7/8	2-3/8	1-11/32	1-1/4

Écrou en "T" "T" Nut

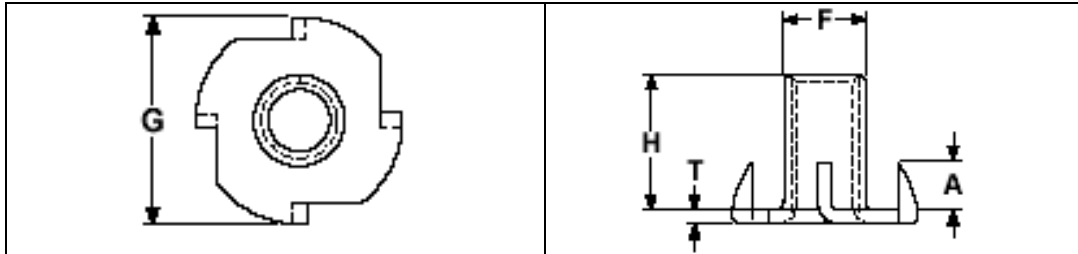

DIA	Acier Steel	A	F	G	H	T	Trou Drill Size
8-32		7/32	.208	23/32	1/4	.030	7/32
10-24	0220 0010	7/32	.243	3/4	5/16	.040	1/4
10-32	0220 0011	7/32	.243	3/4	5/16	.040	1/4
1/4-20	0220 0025	3/16	.305	3/4	1/4	.047	5/16
5/16-18	0220 0031	1/4	.390	7/8	3/8	.063	25/64
3/8-16	0220 0038	11/32	.440	1	7/16	.063	29/64

Écrou à oeil Eye Nut

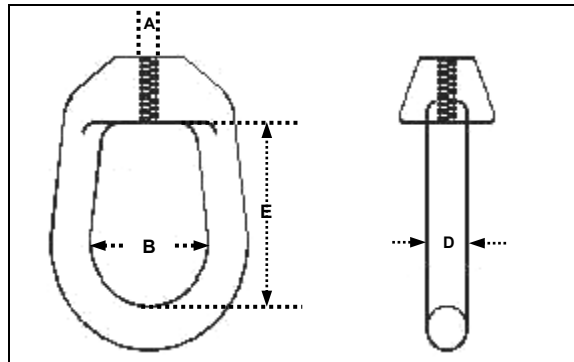

A	Acier nu Plain Steel	B	D	E
1/4-20	0011 0000	3/4	1/4	1-1/16
5/16-18	0011 0001	3/4	1/4	1-1/16
3/8-16	0011 0002	1	5/16	1-1/4
1/2-13	0011 0003	1-1/4	3/8	1-1/2
5/8-11	0011 0004	1-1/2	1/2	2
3/4-10	0011 0005	1-3/4	5/8	2-3/8
7/8-9	0011 0006	2	3/4	2-5/8
1-8	0011 0007	2	3/4	2-5/8
1-1/4(7)	0011 0008	2-1/2	1	

Écrou PAL PAL Nut

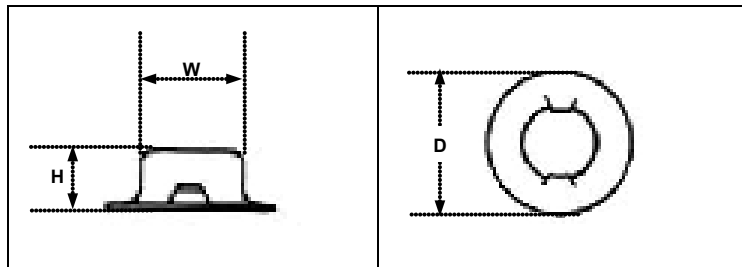

Tige Stud	Acier Steel	D	H	W
3/16		7/16	.202	.220
1/4		1/2	.205	.289
5/16		9/16	.286	.358
3/8		11/16	.234	.419
7/16		7/8	.328	.504
1/2		15/16	.328	.567
5/8		1-3/16	.413	.693
3/4				
1				

Écrou - Rivet Rivnut

	<p style="text-align: center;">A-H Series</p> <p>Filet/Thread: NC 6-32 @ 3/8-16 NF 10-32 @ 3/8-24</p> <p>Métrique/Metric M4 @ M10</p>
	<p style="text-align: center;">A-K Series</p> <p>Filet/Thread: NC 6-32 @ 3/8-16 NF 10-32 @ 3/8-24</p> <p>Métrique/Metric M4 @ M10</p>
	<p style="text-align: center;">A-T Series</p> <p>Filet/Thread: NC 4-40 @ 1/2-13 NF 10-32 @ 1/2-20</p> <p>Métrique/Metric M3 @ M12</p>
	<p style="text-align: center;">A-W Series</p> <p>Filet/Thread: NC 6-32 @ 3/8-16 NF 10-32 @ 3/8-24</p> <p>Métrique/Metric M4 @ M8</p>
	<p style="text-align: center;">A-O Series</p> <p>Filet/Thread: NC 6-32 @ 3/8-16 NF 10-32 @ 3/8-24</p> <p>Métrique/Metric M4 @ M10</p>
	<p style="text-align: center;">Tête plate R-N Series Flat Head</p> <p>Filet/Thread: NC 4-40 @ 1/2-13 NF 10-32 @ 1/2-20</p>
	<p style="text-align: center;">Tête fraisée R-N Series Countersunk Head</p> <p>Filet/Thread: NC 4-40 @ 1/2-13 NF 10-32 @ 1/2-20</p>

Écrou – Rivet AL

AL Rivnut

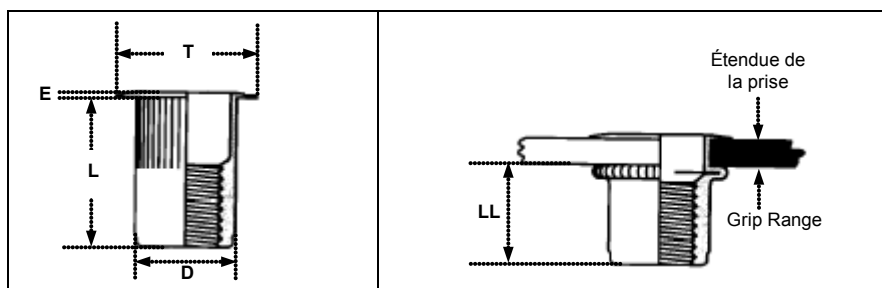

Filet Thread	Acier Steel	Prise Grip	Trou Hole	D	E	L	LL	T
6-32	0881 0608	.020/.080	17/64	.265	.030	.420	.305	.390
6-32	0881 0613	.080/.130	17/64	.265	.030	.470	.305	.390
8-32	0881 0808	.020/.080	17/64	.265	.030	.420	.305	.390
8-32	0881 0813	.080/.130	17/64	.265	.030	.470	.305	.390
10-24	0881 1013	.020/.130	19/64	.296	.030	.475	.315	.415
10-24	0881 1022	.130/.225	19/64	.296	.030	.585	.315	.415
10-32	0881 1113	.020/.130	19/64	.296	.030	.475	.315	.415
10-32	0881 1122	.130/.225	19/64	.296	.030	.585	.315	.415
1/4-20	0881 2516	.027/.165	25/64	.390	.030	.580	.380	.500
1/4-20	0881 2526	.165/.260	25/64	.390	.030	.680	.380	.500
1/4-28	0881 2616	.027/.165	25/64	.390	.030	.580	.380	.500
1/4-28	0881 2626	.165/.260	25/64	.390	.030	.680	.380	.500
5/16-18	0881 3115	.027/.150	17/32	.530	.035	.690	.470	.685
5/16-18	0881 3131	.150/.312	17/32	.530	.035	.805	.425	.685
5/16-24	0881 3215	.027/.150	17/32	.530	.035	.690	.470	.685
5/16-24	0881 3231	.150/.312	17/32	.530	.035	.805	.425	.685
3/8-16	0881 3715	.027/.150	17/32	.530	.035	.690	.470	.685
3/8-16	0881 3731	.150/.312	17/32	.530	.035	.805	.425	.685
3/8-24	0881 3815	.027/.150	17/32	.530	.035	.690	.470	.685
3/8-24	0881 3831	.150/.312	17/32	.530	.035	.805	.425	.685

Manchon fileté et relieur Sleeve Nut and Binder Post

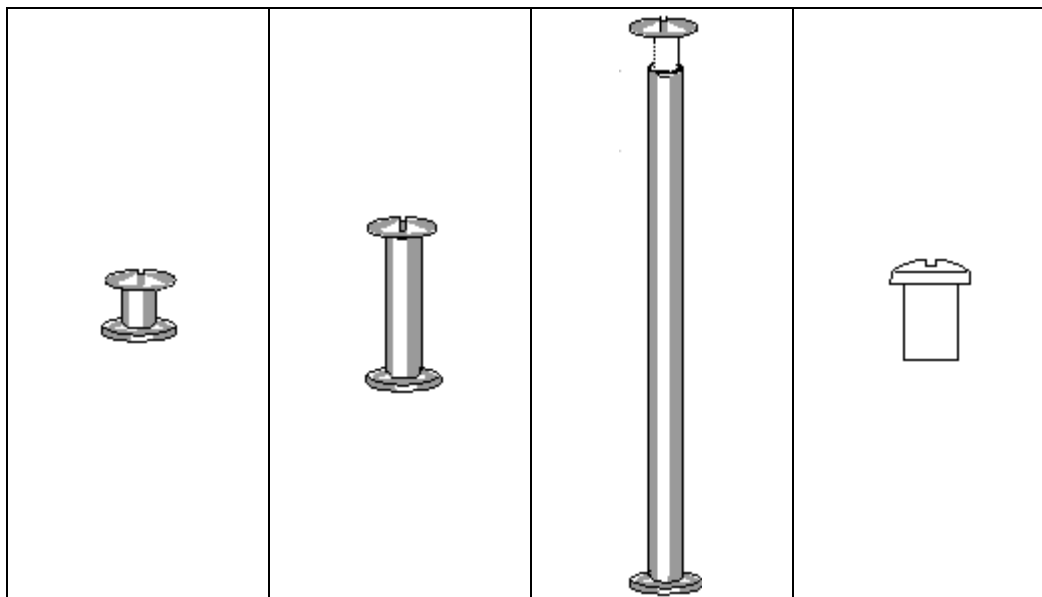

**DISPONIBLE EN PLUSIEURS DIMENSIONS
AVAILABLE IN MANY SIZES**

Écrou de blocage tout métal All Metal Locknut (Stover)

DIN 980

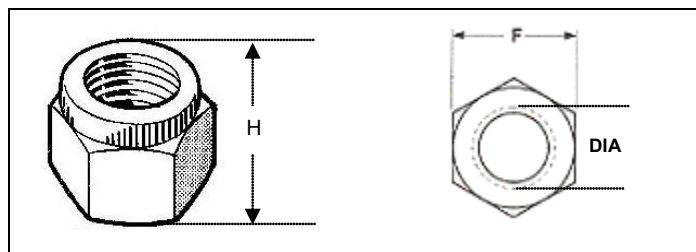

DIA - Pas/Pitch	Acier zingué / Zinc Plated		F	H
	Classe/Class 8	Classe/Class 10		
M4-0.70	9635 0004		7.0	4.0
M5-0.80	9635 0005	9648 0005	8.0	5.0
M6-1.00	9635 0006	9648 0006	10.0	6.0
M8-1.25	9635 0008	9648 0008	13.0	7.5
M8-1.00	9636 0008		13.0	7.5
M10-1.50	9635 0010	9648 0010	17.0	9.0
M10-1.25	9636 0010		17.0	9.0
M10-1.00	9636 0011		17.0	9.0
M12-1.75	9635 0012	9648 0012	19.0	11.0
M12-1.50	9636 0012		19.0	11.0
M12-1.25	9636 0013		19.0	11.0
M14-2.00	9635 0014	9648 0014	22.0	12.0
M14-1.50	9636 0014	0945 0014	22.0	12.0
M16-2.00	9635 0016	9648 0016	24.0	16.0
M16-1.50	9636 0016		24.0	16.0
M18-2.50	9635 0018	9648 0018	27.0	18.0
M18-1.50	9636 0018		27.0	18.0
M20-2.50	9635 0020	9648 0020	30.0	20.0
M20-2.00	9636 0020		30.0	20.0
M20-1.50	9636 0021		30.0	20.0
M22-2.50	9635 0022	9648 0022	32.0	22.0
M22-1.50	9636 0022		32.0	22.0
M24-3.00	9635 0024	9648 0024	36.0	24.0
M24-1.50	9636 0024		36.0	24.0
M27-3.00	9635 0027		41.0	27.0
M30-3.50	9635 0030	9648 0030	46.0	30.0
M30-2.00	9636 0030		46.0	30.0
M36-4.00	9635 0036	9648 0036	55.0	36.0
M42-4.00	9635 0042		65.0	43.0

Écrou à collet de nylon Nylon Insert Locknut

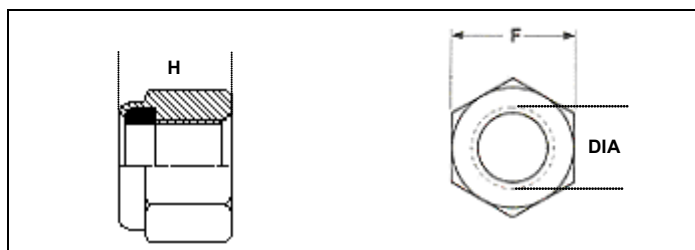

DIA	DIN 985							
	Acier zingué / Steel Zinc Plated		F	H	Acier inoxydable Stainless Steel		F	H
	Classe/Class 8	Classe/Class 10			A2 (18-8)	A4 (316)		
M2 – 0.40	9634 0002							
M2.5 – 0.45	9634 0025		5.0	3.8	7330 0025		5.0	3.8
M2.6 – 0.45	9634 0026		5.0	3.35				
M3 – 0.50	9634 0003		5.5	4.0	7330 0003	7331 0003	5.5	4.0
M4 – 0.70	9634 0004		7.0	5.0	7330 0004	7331 0004	7.0	5.0
M5 – 0.80	9634 0005		8.0	5.0	7330 0005	7331 0005	8.0	6.3
M6 – 1.00	9634 0006	9637 0006	10.0	6.0	7330 0006	7331 0006	10.0	8.0
M7 – 1.00	9634 0007		11.0	7.5				
M8 – 1.25	9634 0008	9637 0008	13.0	8.0	7330 0008	7331 0008	13.0	9.5
M8 – 1.00	9647 0008		13.0	8.0				
M10 – 1.50	9634 0010	9637 0010	17.0	10.0	7330 0010	7331 0010	17.0	11.5
M10 – 1.25	9647 0011		17.0	10.0				
M10 – 1.00	9647 0010		17.0	10.0				
M12 – 1.75	9634 0012	9637 0012	19.0	12.0	7330 0012	7331 0012	19.0	14.0
M12 – 1.50	9647 0015		19.0	12.0				
M12 – 1.25	9647 0013		19.0	12.0				
M12 – 1.00	9647 0012		19.0	12.0				
M14 – 2.00	9634 0014	9637 0014	22.0	14.0	7330 0014		22.0	16.0
M14 – 1.50	9647 0014		22.0	14.0				
M16 – 2.00	9634 0016	9637 0016	24.0	16.0	7330 0016	7331 0016	24.0	18.0
M16 – 1.50	9647 0016		24.0	16.0				
M18 – 2.50	9634 0018	9637 0018	27.0	18.5	7330 0018		27.0	20.0
M18 – 2.00	9647 0019		27.0	18.5				
M18 – 1.50	9647 0018		27.0	18.5				
M20 – 2.50	9634 0020	9637 0020	30.0	20.0	7330 0020	7331 0020	30.0	22.0
M20 – 2.00	9647 0021		30.0	20.0				
M20 – 1.50	9647 0020		30.0	20.0				
M22 – 2.50	9634 0022	9637 0022	32.0	22.0	7330 0022			
M22 – 2.00	9647 0023		32.0	22.0				
M22 – 1.50	9647 0022		32.0	22.0				

Écrou à collet de nylon Nylon Insert Locknut

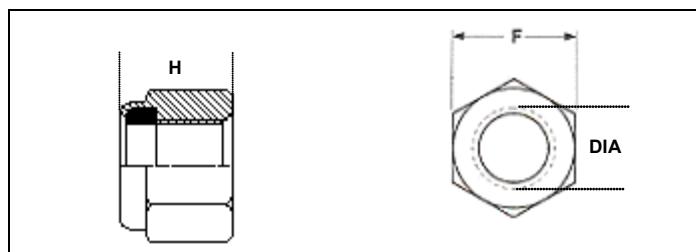

DIA	DIN 985							
	Acier zingué / Steel Zinc Plated		F	H	Acier inoxydable Stainless Steel		F	H
	Classe/Class 8	Classe/Class 10			A2 (18-8)	A4 (316)		
M24 – 3.00	9634 0024	9637 0024	36.0	24.0	7330 0024	7331 0024	36.0	28.0
M24 – 2.00	9647 0024		36.0	24.0				
M24 – 1.50	9647 0025		36.0	24.0				
M27 – 3.00	9634 0027		41.0	27.0	7330 0027		41.0	30.8
M27 – 2.00	9647 2700		41.0	27.0				
M27 – 1.50	9647 0027		41.0	27.0				
M30 – 3.50	9634 0030		46.0	30.0	7330 0030		46.0	34.5
M30 – 2.00	9647 0031		46.0	30.0				
M30 – 1.50	9647 0030		46.0	30.0				
M33 – 3.50	9634 0033		50.0	33.0				
M33 – 1.50	9647 0033		50.0	33.0				
M36 – 4.00	9634 0036		55.0	36.0				
M36 – 1.50	9647 0036		55.0	36.0				
M42 – 4.50	9634 0042		65.0	42.0				
M45 – 4.50	9634 0045		70.0	45.0				
M48 – 5.00	9634 0048		75.0	48.0				

Écrou hexagonal KEPS

Hexagon KEPS Nut

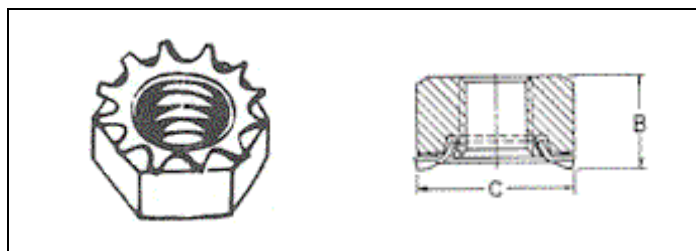

DIA - Pas/Pitch	Acier zingué / Zinc Plated	Acier inoxydable Stainless Steel A2 (18-8)	B	C
M3-0.50			3.2	6.3
M4-0.70	0602 0004		4.0	8.0
M5-0.80	0602 0005		5.1	9.2
M6-1.00	0602 0006		6.1	11.0
M8-1.25	0602 0008		7.9	14.9
M10-1.50	0602 0010		9.6	19.5
M12-1.75			12.0	21.0

Écrou carré Square Nut

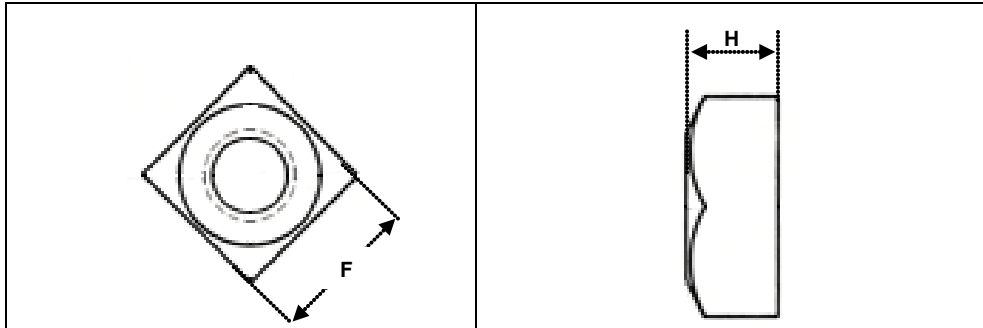

DIA - Pas/Pitch	Acier nu Plain Steel	Acier zingué Steel Zinc Plated	F	H
M3 - 0.50				
M4 - 0.70				
M6 - 1.00	0603 0006		10.0	5.0
M8 - 1.25				
M10 - 1.50				

Écrou à oreilles forgé Wing Nut Forged

DIN 40

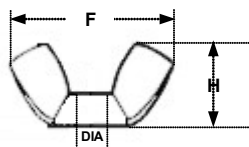

DIA - Pas/Pitch	Acier zingué Steel Zinc Plated	Acier inoxydable Stainless Steel A2 (18-8)	F	H
M3 - 0.50	9649 0003		17.6	8.6
M4 - 0.70	9649 0004	0924 0004	17.6	8.6
M5 - 0.80	9649 0005	0924 0005	22.5	11.0
M6 - 1.00	9649 0006	0924 0006	27.8	13.6
M8 - 1.25	9649 0008	0924 0008	30.3	14.8
M10 - 1.50	9649 0010	0924 0010	36.2	17.7
M12 - 1.75	9649 0012		49.4	24.1
M16 - 2.00	9649 0016		64.0	30.0
M20 - 2.50	9649 0020			

Écrou borne Acorn Nut (Cap)

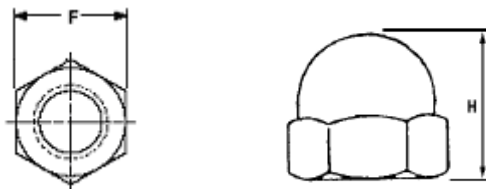

DIA - Pas/Pitch	Acier zingué Steel Zinc Plated	Acier inoxydable Stainless Steel A2 (18-8)	F	H
M3 - 0.50	0612 0003	7332 0003	5.5	6.0
M4 - 0.70	0612 0004	7332 0004	7.0	8.0
M5 - 0.80	0612 0005	7332 0005	8.0	10.0
M6 - 1.00	0612 0006	7332 0006	10.0	12.0
M8 - 1.25	0612 0008	7332 0008	13.0	15.0
M10 - 1.50	0612 0010	7332 0010	17.0	18.0
M12 - 1.75	0612 0012	7332 0012	19.0	22.0
M16 - 2.00	0612 0016	7332 0016	24.0	28.0
M20 - 2.50	0612 0020	7332 0020	30.0	34.0
M24 - 3.00			36.0	42.0