

RONDELLE / WASHER

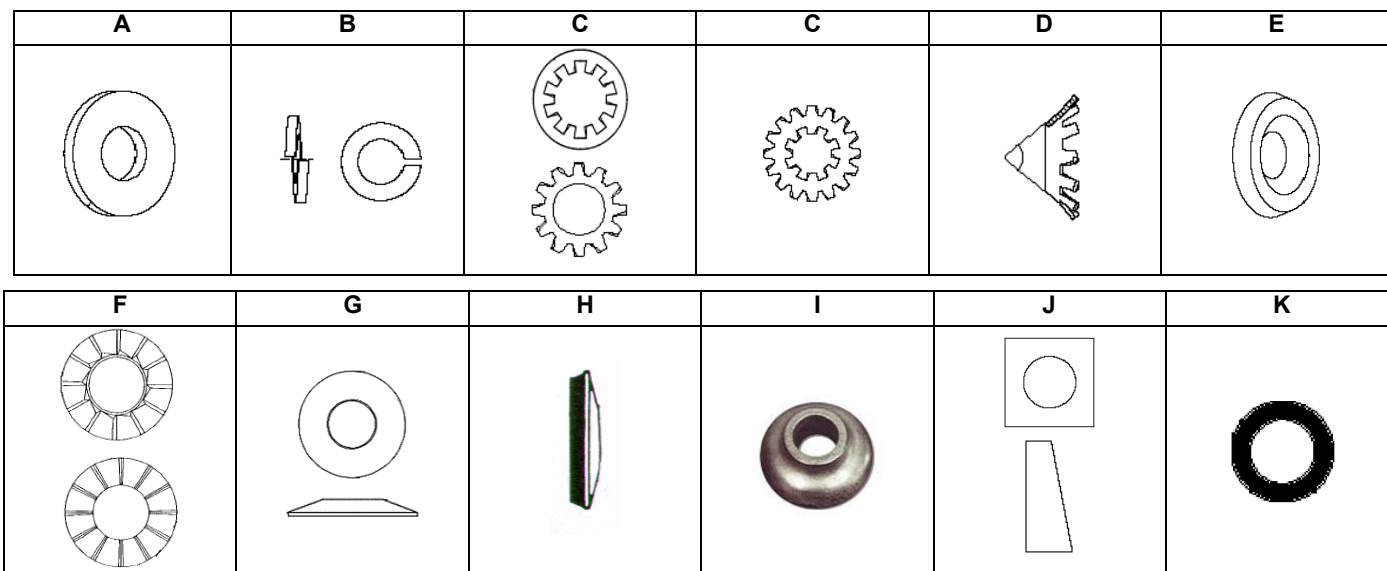

	Description	Page	
A	Rondelle plate (acier, SAE, USS, acier inoxydable, laiton, aluminium, cuivre, bronze, Grade 8, L9, fibre, F436, nylon)	Washer Flat (steel, SAE, USS, stainless steel, brass, aluminum, copper, silicon bronze, Grade 8, L9, fiber, F436, nylon)	482-490
A	Rondelle plate métrique	Washer Flat Metric	M128-M130
B	Rondelle frein	Lockwasher	491-494
B	Rondelle frein métrique	Lockwasher Metric	M131-M132
C	Rondelle frein à dents	Lockwasher Internal, External Tooth	495-497
C	Rondelle frein à dents métrique	Lockwasher Internal, External Tooth Metric	M133
D	Rondelle conique à denture externe	Lockwasher Countersunk External Tooth	498
E	Rondelle de finition	Washer Countersunk Finishing	499
F	Rondelle Disc-Lock	Washer Disc-Lock	500
F	Rondelle Nord-Lock	Washer Nord-Lock	501-502
G	Rondelle Belleville	Washer Belleville	503
H	Rondelle d'obturation	Washer Sealing	504
I	Rondelle O. G.	Washer O. G.	505
J	Plaquette oblique	Washer Bevel	506
K	Joint torique	O-Ring Seal	514

Rondelle plate Flat Washer

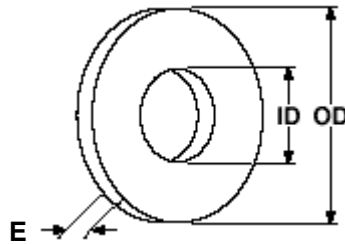

Pour boulon For Bolt	#	Matériau Material	ID	OD	E
#1	5045 0001	Acier inoxydable 18-8 / Stainless Steel 18-8			
#2	5045 0002	Acier inoxydable 18-8 / Stainless Steel 18-8	3/32	7/32	.020
#2	0150 0002	SAE acier zingué / Steel Zinc Plated	3/32	7/32	.020
#2S	0509 0002	Laiton / Brass	.092	3/16	.018
#3	5045 0003	Acier inoxydable 18-8 / Stainless Steel 18-8	7/64	3/8	.031
#4	0150 0004	SAE acier zingué / Steel Zinc Plated	1/8	5/16	.040/.025
#4	5045 0004	Acier inoxydable 18-8 / Stainless Steel 18-8	1/8	5/16	.031
#4	0364 ABUP4	Aluminium / Aluminum	1/8	3/8	.032
#4	0363 SBUP4	Acier nu / Plain Steel	1/8	7/16	.040
#4	0509 0109	Laiton / Brass	.119	9/32	.025
#5	5045 0005	Acier inoxydable 18-8 / Stainless Steel 18-8	.130	7/16	.040
#5	0509 0005	Laiton / Brass	.130	7/16	.040
#5	0364 ABUP5	Aluminium / Aluminum	5/32	3/8	.032
#5	0363 SBUP5	Acier nu / Plain Steel	5/32	1/2	.050
#6	5045 0006	Acier inoxydable 18-8 / Stainless Steel 18-8	5/32	3/8	.031
#6S	0509 0140	Laiton / Brass	.147	5/16	.028
#6L	0509 0141	Laiton / Brass	.147	3/8	.032
#6	0364 ABUP6	Aluminium / Aluminum	3/16	7/16	.037
#6	0363 SBUP6	Acier nu / Plain Steel	3/16	1/2	.047
#6	0365 SSBUP6	Acier inoxydable 18-8 / Stainless Steel 18-8	3/16	7/16	.031
#6	0150 0006	SAE acier zingué / Steel Zinc Plated	5/32	3/8	.065/.036
#6	5093 0125	Acier inoxydable 316 / Stainless Steel 316	5/32	3/8	.031
#8	5045 0008	Acier inoxydable 18-8 / Stainless Steel 18-8	11/64	3/8	.031
#8S	0509 0152	Laiton / Brass	11/64	3/8	.032
#8L	0509 0153	Laiton / Brass	11/64	7/16	.036
#8	0364 ABUP8	Aluminium / Aluminum	1/4	11/16	.047
#8	0149 0008	SAE acier nu / Plain Steel	3/16	7/16	.065/.031
#8	0150 0008	SAE acier zingué / Steel Zinc Plated	3/16	7/16	.065/.036
#8	5093 0152	Acier inoxydable 316 / Stainless Steel 316	11/64	3/8	.031
#8	0679 0008	Nylon	11/64	3/8	.062
#8	0144 0008	Acier nu / Plain Steel USS	3/16	7/16	.065/.036
#8	0146 0008	Acier zingué / Steel Zinc Plated USS	3/16	7/16	.065/.036
#8	1100 4002	Cuivre / Copper	.160	1/2	.042

Rondelle plate Flat Washer

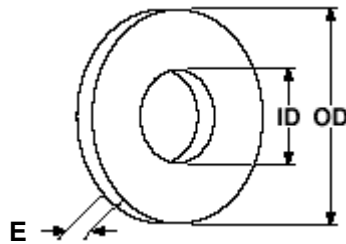

Pour boulon For Bolt	#	Matériau Material	ID	OD	E
#10	0149 0010	SAE acier nu / Plain Steel	7/32	1/2	.065/.036
#10	0150 0010	SAE acier zingué / Steel Zinc Plated	7/32	1/2	.065/.036
#10	0144 0010	Acier nu / Plain Steel USS	1/4	9/16	.065/.036
#10	0146 0010	Acier zingué / Steel Zinc Plated USS	1/4	9/16	.065/.036
#10	5045 0010	Acier inoxydable 18-8 / Stainless Steel 18-8	13/64	7/16	.031
#10	5093 0187	Acier inoxydable 316 / Stainless Steel 316	.200	7/16	.037
#10S	0509 0187	Laiton / Brass	13/64	7/16	.036
#10L	0509 0188	Laiton / Brass	13/64	1/2	.040
#10	0527 0187	Bronze silicieux / Silicon Bronze	13/64	7/16	.031
#10	0036 0187	Aluminium / Aluminum	.203	7/16	.037
#10COM	5099 0010	Acier inoxydable 18-8 commercial / Commercial Stainless Steel 18-8	.203	3/8	.050
#10	0483 2020	Acier inoxydable 18-8 / Stainless Steel 18-8	13/64	5/8	.062
#10	0483 2022	Acier inoxydable 18-8 / Stainless Steel 18-8	13/64	3/4	.060
#10	0162 1022	Acier zingué / Steel Zinc Plated (Fender)	3/16	3/4	.060
#10	5044 1022	Acier inoxydable 18-8 / Stainless Steel 18-8	3/16	3/4	.060
#10	0162 1024	Acier zingué / Steel Zinc Plated (Fender)	7/32	1	.080/.051
#10	5044 1024	Acier inoxydable 18-8 / Stainless Steel 18-8	3/16	1	.060
Special	0036 0205	Aluminium / Aluminum	.205		
#12	5045 0012	Acier inoxydable 18-8 / Stainless Steel 18-8	15/64	1/2	.040
#12S	0509 0218	Laiton / Brass	.227	5/8	.050
#12L	0509 0219	Laiton / Brass	.243	.850	1/8
1/4	0149 0025	SAE acier nu / Plain Steel	9/32	5/8	.080/.051
1/4	0150 0025	SAE acier zingué / Steel Zinc Plated	9/32	5/8	.080/.051
1/4	0144 0025	Acier nu / Plain Steel USS	5/16	3/4	.080/.051
1/4	0146 0025	Acier zingué / Steel Zinc Plated USS	5/16	3/4	.080/.051
1/4	0624 0025	Acier zingué jaune / Yellow Zinc Plated	5/16	3/4	.080/.051
1/4	5045 0025	Acier inoxydable 18-8 / Stainless Steel 18-8	9/32	5/8	.050
1/4	5093 0250	Acier inoxydable 316 / Stainless Steel 316	9/32	5/8	.045
1/4S	0509 0250	Laiton / Brass	.260	9/16	.040
1/4L	0509 0251	Laiton / Brass	.260	11/16	.051
1/4	5027 0250	Bronze silicieux / Silicon Bronze	.260	11/16	.047
1/4	0036 0250	Aluminium / Aluminum	.260	11/16	.047
1/4	5099 0250	Acier inoxydable 18-8 commercial / Commercial Stainless Steel 18-8	.281	11/16	.050

Rondelle plate Flat Washer

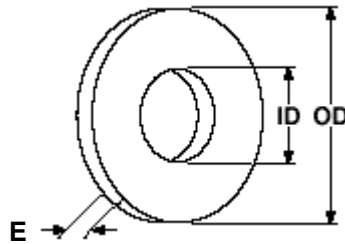

Pour boulon For Bolt	#	Matériau Material	ID	OD	E
1/4	0162 2525	Acier zingué / Steel Zinc Plated (Fender)	9/32	1-3/16	.031
1/4	0162 2526	Acier zingué / Steel Zinc Plated (Fender)	9/32	1-1/4	.031
1/4	5044 2524	Acier inoxydable / Stainless Steel (Fender)	9/32	1	.050
1/4	5044 2526	Acier inoxydable / Stainless Steel (Fender)	9/32	1-1/4	.050
1/4	5044 2528	Acier inoxydable / Stainless Steel (Fender)	9/32	1-1/2	.050
1/4	0679 2518	Nylon	.257	1/2	1/16
1/4	0679 2519	Nylon	.260	9/16	.062
1/4	0679 2578	Nylon			
1/4	0679 2588	Nylon	.257	7/8	.062
1/4	0438 0025	F436 de structure zingué jaune / Structural Yellow Zinc F436	9/32	5/8	.062
1/4	0855 0025	Acier galvanisé / Hot Dip Galvanized	5/16	3/4	.063
1/4	0703 0025	Acier plaqué au cadmium / Steel Cadmium Plated	5/16	3/4	.063
1/4	0148 0025	Zingué jaune Grade 8 Yellow Zinc Plated	5/16	3/4	.072/.055
1/4	0101 0025	L9	.286/.276	.640/.620	.071/.056
1/4	0728 2518	Fibre / Fiber	9/32	1/2	1/16
#16S	0509 0265	Laiton / Brass	.282	5/8	.040
#16L	0509 0266	Laiton / Brass	.282	3/4	.064
#18S	0509 0296	Laiton / Brass	.310	11/16	.051
#18L	0509 0297	Laiton / Brass	.310	7/8	.064
5/16	0149 0031	SAE acier nu / Plain Steel	11/32	11/16	.080/.051
5/16	0150 0031	SAE acier zingué / Steel Zinc Plated	11/32	11/16	.080/.051
5/16	0144 0031	Acier nu / Plain Steel USS	3/8	7/8	.104/.064
5/16	0146 0031	Acier zingué / Steel Zinc Plated USS	3/8	7/8	.104/.064
5/16	5045 0031	Acier inoxydable 18-8 / Stainless Steel 18-8	.344	3/4	.050
5/16	5093 0312	Acier inoxydable 316 / Stainless Steel 316	.344	3/4	.045
5/16S	0509 0312	Laiton / Brass	.337	3/4	.064
5/16L	0509 0313	Laiton / Brass	.337	7/8	.064
5/16	0527 0312	Bronze silicieux / Silicon Bronze	21/64	3/4	.065
5/16	0527 0313	Bronze silicieux / Silicon Bronze	.337	7/8	.064
5/16	0036 0312	Aluminium / Aluminum	3/8	7/8	.064
5/16	0162 3124	Acier zingué / Steel Zinc Plated (Fender)	11/32	1	.064
5/16	0162 3126	Acier zingué / Steel Zinc Plated (Fender)	11/32	1-1/4	.065
5/16	0162 3128	Acier zingué / Steel Zinc Plated (Fender)	11/32	1-1/2	.083

Rondelle plate Flat Washer

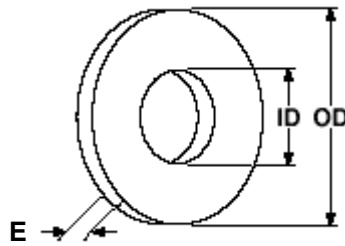

Pour boulon For Bolt	#	Matériau Material	ID	OD	E
5/16	5044 3128	Acier inoxydable / Stainless Steel (Fender)	11/32	1-1/2	.063
5/16	0438 0031	F436 de structure zingué jaune / Structural Yellow Zinc F436	11/32	11/16	.063
5/16	0855 0031	Acier galvanisé / Hot Dip Galvanized	3/8	7/8	.093
5/16	0148 0031	Zingué jaune Grade 8 Yellow Zinc Plated	11/32	11/16	.072/.055
5/16	0101 0031	L9	.349/.339	.703/.681	.071/.056
	0728 2723	Fibre / Fiber	17/64	7/8	1/4
5/16	0703 0031	Acier plaqué au cadmium / Steel Cadmium Plated	3/8	7/8	.104/.064
	0728 3325	Fibre / Fiber	21/64	1-1/16	1/4
	0728 3327	Fibre / Fiber	21/64	1-13/32	1/4
3/8	0149 0038	SAE acier nu / Plain Steel	13/32	13/16	.080/.051
3/8	0150 0038	SAE acier zingué / Steel Zinc Plated	13/32	13/16	.080/.051
3/8	0144 0038	Acier nu / Plain Steel USS	7/16	1	.104/.064
3/8	0146 0038	Acier zingué / Steel Zinc Plated USS	7/16	1	.104/.064
3/8	0146 0039	Acier zingué / Steel Zinc Plated	7/16	3/4	.054
3/8	5045 0037	Acier inoxydable 18-8 / Stainless Steel 18-8	.391	.875	.050
3/8	5093 0375	Acier inoxydable 316 / Stainless Steel 316	.406	.875	.045
3/8S	0509 0375	Laiton / Brass	.395	7/8	.064
3/8L	0509 0376	Laiton / Brass	.395	1	.081
3/8	0527 0375	Bronze silicieux / Silicon Bronze	.391	7/8	.064
3/8	0527 0376	Bronze silicieux / Silicon Bronze	25/64	1	.065
3/8	0036 0375	Aluminium / Aluminum	.391	1	.081
3/8	5099 0375	Acier inoxydable 18-8 commercial / Commercial Stainless Steel 18-8	.391	1	.063
3/8	0162 3728	Acier zingué / Steel Zinc Plated (Fender)	13/32	1-1/2	.063
3/8	0162 3732	Acier zingué / Steel Zinc Plated (Fender)	13/32	2	.063
3/8	5044 3726	Acier inoxydable / Stainless Steel (Fender)	13/32	1-1/4	.063
3/8	5044 3728	Acier inoxydable / Stainless Steel (Fender)	13/32	1-1/2	.063
3/8	0438 0038	F436 de structure zingué jaune / Structural Yellow Zinc F436	13/32	13/16	.063
3/8	0624 0037	Acier zingué jaune / Yellow Zinc Plated	7/16	1	.104/.064
3/8	0855 0038	Acier galvanisé / Hot Dip Galvanized	7/16	1	.104/.064
3/8	0148 0038	Zingué jaune Grade 8 Yellow Zinc Plated	13/32	13/16	.055
3/8	0101 0038	L9	.411/.401	.827/.805	.112/.090
3/8	0703 0037	Acier plaqué au cadmium / Steel Cadmium Plated	7/16	1	.104/.064

Rondelle plate Flat Washer

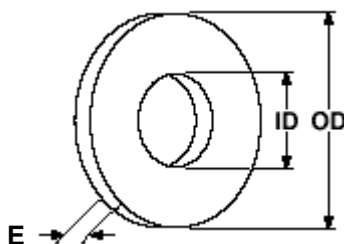

Pour boulon For Bolt	#	Matériau Material	ID	OD	E
7/16	0149 0043	SAE acier nu / Plain Steel	15/32	59/64	.080/.051
7/16	0150 0043	SAE acier zingué / Steel Zinc Plated	15/32	59/64	.080/.051
7/16	0144 0043	Acier nu / Plain Steel USS	1/2	1-1/4	.104/.064
7/16	0146 0043	Acier zingué / Steel Zinc Plated USS	1/2	1-1/4	.104/.064
7/16	5045 0043	Acier inoxydable 18-8 / Stainless Steel 18-8	.500	1.125	.050
7/16	5093 0437	Acier inoxydable 316 / Stainless Steel 316	15/32	7/8	.062
7/16	0509 0437	Laiton / Brass	1/2	1-1/8	.081
7/16	0527 0043	Bronze silicieux / Silicon Bronze		1	
7/16	5099 0437	Acier inoxydable 18-8 commercial / Commercial Stainless Steel 18-8	.469	1-1/8	.063
7/16	0438 0043	F436 de structure zingué jaune / Structural Yellow Zinc F436	15/32	59/64	.063
7/16	0624 0043	Acier zingué jaune / Yellow Zinc Plated	1/2	1-1/4	.104/.064
7/16	0855 0043	Acier galvanisé / Hot Dip Galvanized	1/2	1-1/4	.104/.064
7/16	0148 0043	Zingué jaune Grade 8 Yellow Zinc Plated	15/32	59/64	.072/.055
7/16	0101 0043	L9	.474/.464	.937/.915	.112/.090
7/16	0703 0043	Acier plaqué au cadmium / Steel Cadmium Plated	1/2	1-1/4	.104/.064
1/2	0149 0050	SAE acier nu / Plain Steel	17/32	1-1/16	.121/.097
1/2	0150 0050	SAE acier zingué / Steel Zinc Plated	17/32	1-1/16	.121/.097
1/2	0144 0050	Acier nu / Plain Steel USS	9/16	1-3/8	.121/.097
1/2	0146 0050	Acier zingué / Steel Zinc Plated USS	9/16	1-3/8	.121/.097
1/2	5045 0050	Acier inoxydable 18-8 / Stainless Steel 18-8	.562	1.250	.055/.062
1/2	5093 0500	Acier inoxydable 316 / Stainless Steel 316	.531	1.250	.055
1/2	0509 0500	Laiton / Brass	9/16	1-1/4	.081
1/2	0527 0500	Bronze silicieux / Silicon Bronze	.525	1	.063
1/2	0527 0501	Bronze silicieux / Silicon Bronze	9/16	1-1/4	.095
1/2	0036 0500	Aluminium / Aluminum	.563	1-1/4	.091
1/2	0162 5032	Acier zingué / Steel Zinc Plated (Fender)	17/32	2	.063
1/2	5044 5032	Acier inoxydable / Stainless Steel (Fender)	17/32	2	.063
1/2	5044 5033	Acier inoxydable / Stainless Steel (Fender)	17/32	2	.100
1/2	0436 0050	F436 de structure / Structural F436	17/32	1-1/16	.177/.097
1/2	0438 0050	F436 de structure zingué jaune / Structural Yellow Zinc F436	17/32	1-1/16	.177/.097
1/2	0439 0050	F436 de structure galvanisé / Structural Galvanized F436	17/32	1-1/16	.177/.097
1/2	0624 0050	Acier zingué jaune / Yellow Zinc Plated	9/16	1-3/8	.121/.097
1/2	0855 0050	Acier galvanisé / Hot Dip Galvanized	9/16	1-3/8	.121/.097
1/2	0148 0050	Zingué jaune Grade 8 Yellow Zinc Plated	9/16	1-3/8	.121/.097
1/2	0101 0050	L9	.536/.526	1.092/1.055	.112/.090
1/2	0703 0050	Acier plaqué au cadmium / Steel Cadmium Plated	9/16	1-3/8	.121/.097

Rondelle plate Flat Washer

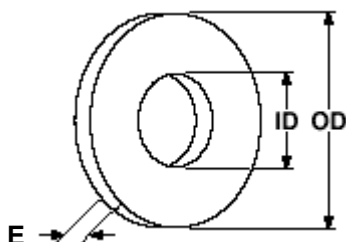

Pour boulon For Bolt	#	Matériau Material	ID	OD	E
1/2	0698 5002	Nylon			.032
1/2	0698 5171	Nylon	.515	.716	.015
1/2	0957 5024	Nylon	.531	1	.062
9/16	0149 0056	SAE acier nu / Plain Steel	19/32	1-3/16	.121/.074
9/16	0150 0056	SAE acier zingué / Steel Zinc Plated	19/32	1-3/16	.121/.074
9/16	0144 0056	Acier nu / Plain Steel USS	5/8	1-1/2	.132/.086
9/16	0146 0056	Acier zingué / Steel Zinc Plated USS	5/8	1-1/2	.132/.086
9/16	5045 0056	Acier inoxydable 18-8 / Stainless Steel 18-8	.578	1-1/16	.063
9/16	0438 0056	F436 de structure zingué jaune / Structural Yellow Zinc F436	19/32	1-3/16	.110
9/16	0101 0056	L9	.599/.589	1.186/1.149	.112/.090
	0728 5935	Fibre / Fiber	19/32	2-3/8	1/4
	0728 5938	Fibre / Fiber	19/32	2-3/4	1/4
5/8	0149 0062	SAE acier nu / Plain Steel	21/32	1-5/16	.121/.074
5/8	0150 0062	SAE acier zingué / Steel Zinc Plated	21/32	1-5/16	.121/.074
5/8	0144 0062	Acier nu / Plain Steel USS	11/16	1-3/4	.160/.108
5/8	0146 0062	Acier zingué / Steel Zinc Plated USS	11/16	1-3/4	.160/.108
5/8	5045 0062	Acier inoxydable 18-8 / Stainless Steel 18-8	.688	1-1/2	.062
5/8	5093 0625	Acier inoxydable 316 / Stainless Steel 316	.688	1-1/2	.075
5/8	0509 0625	Laiton / Brass	11/16	1-1/2	.102
5/8	0527 0625	Bronze silicieux / Silicon Bronze	11/16	1-1/2	.092
5/8	0036 0625	Aluminium / Aluminum	.687	1-1/2	.095
5/8	0855 0062	Acier galvanisé / Hot Dip Galvanized	11/16	1-3/4	.160/.108
5/8	0148 0062	Zingué jaune Grade 8 Yellow Zinc Plated	21/32	1-3/4	.125
5/8	0101 0062	L9	.623/.649	1.342/1.305	.174/.146
5/8	0703 0062	Acier plaqué au cadmium / Steel Cadmium Plated	11/16	1-3/4	.160/.108
5/8	0436 0062	F436 de structure / Structural F436	11/16	1-5/16	.177/.122
5/8	0438 0062	F436 de structure zingué jaune / Structural Yellow Zinc F436	11/16	1-5/16	.177/.122
5/8	0439 0062	F436 de structure galvanisé / Structural Galvanized F436	11/16	1-5/16	.177/.122
5/8	0698 6236	Nylon		2-1/2	
3/4	0149 0075	SAE acier nu / Plain Steel	13/16	1-1/2	.160/.108
3/4	0150 0075	SAE acier zingué / Steel Zinc Plated	13/16	1-1/2	.160/.108
3/4	0144 0075	Acier nu / Plain Steel USS	13/16	2	.177/.122
3/4	0146 0075	Acier zingué / Steel Zinc Plated USS	13/16	2	.177/.122
3/4	5045 0075	Acier inoxydable 18-8 / Stainless Steel 18-8	.812	1-3/4	.075
3/4	5093 0750	Acier inoxydable 316 / Stainless Steel 316	.812	1-3/4	.075

Rondelle plate Flat Washer

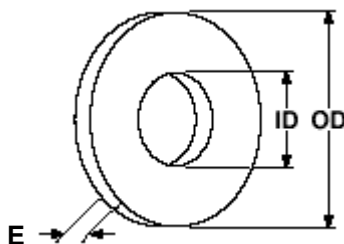

Pour boulon For Bolt	#	Matériau Material	ID	OD	E
3/4	0509 0750	Laiton / Brass	13/16	1-7/8	.114
3/4	0527 0750	Bronze silicieux / Silicon Bronze	13/16	1-7/8	.102
3/4	0036 0750	Aluminium / Aluminum	.812	1-7/8	.095
3/4	5099 0750	Acier inoxydable 18-8 commercial / Commercial Stainless Steel 18-8	.812	1-7/8	.095
3/4	0624 0075	Acier zingué jaune / Yellow Zinc Plated	13/16	2	.177/.122
3/4	0855 0075	Acier galvanisé / Hot Dip Galvanized	13/16	2	.177/.122
3/4	0148 0075	Zingué jaune Grade 8 Yellow Zinc Plated	13/16	2	.125
3/4	0101 0075	L9	.819/.805	1.499/1.462	.174/.146
3/4	0703 0075	Acier plaqué au cadmium / Steel Cadmium Plated	13/16	2	.177/.122
3/4	0436 0075	F436 de structure / Structural F436	13/16	1-5/32	.177/.122
3/4	0438 0075	F436 de structure zingué jaune / Structural Yellow Zinc F436	13/16	1-5/32	.177/.122
3/4	0439 0075	F436 de structure galvanisé / Structural Galvanized F436	13/16	1-5/32	.177/.122
7/8	0149 0087	SAE acier nu / Plain Steel	15/16	1-3/4	.160/.108
7/8	0150 0087	SAE acier zingué / Steel Zinc Plated	15/16	1-3/4	.160/.108
7/8	0144 0087	Acier nu / Plain Steel USS	15/16	2-1/4	.192/.136
7/8	0146 0087	Acier zingué / Steel Zinc Plated USS	15/16	2-1/4	.192/.136
7/8	0703 0087	Acier plaqué au cadmium / Steel Cadmium Plated	15/16	2-1/4	.192/.136
7/8	5045 0087	Acier inoxydable 18-8 / Stainless Steel 18-8	.938	2	.109/.095
7/8	5093 0875	Acier inoxydable 316 / Stainless Steel 316	.938	2-1/4	.105
7/8	0509 0875	Laiton / Brass	15/16	2-1/4	.128
7/8	0527 0875	Bronze silicieux / Silicon Bronze	15/16	2-1/4	.128
7/8	5099 0875	Acier inoxydable 18-8 commercial / Commercial Stainless Steel 18-8	.938	2-1/4	.095
7/8	0855 0087	Acier galvanisé / Hot Dip Galvanized	15/16	2-1/4	.192/.136
7/8	0148 0087	Zingué jaune Grade 8 Yellow Zinc Plated	15/16	2-1/4	.146
7/8	0101 0087	L9	.945/.931	1.780/1.743	.174/.146
7/8	0436 0087	F436 de structure / Structural F436	15/16	1-3/4	.177/.136
7/8	0438 0087	F436 de structure zingué jaune / Structural Yellow Zinc F436	15/16	1-3/4	.177/.136
7/8	0439 0087	F436 de structure galvanisé / Structural Galvanized F436	15/16	1-3/4	.177/.136
1	0149 0100	SAE acier nu / Plain Steel	1-1/16	2	.160/.108
1	0150 0100	SAE acier zingué / Steel Zinc Plated	1-1/16	2	.160/.108
1	0144 0100	Acier nu / Plain Steel USS	1-1/16	2-1/2	.192/.136
1	0146 0100	Acier zingué / Steel Zinc Plated USS	1-1/16	2-1/2	.192/.136
1	0703 0100	Acier plaqué au cadmium / Steel Cadmium Plated	1-1/16	2-1/2	.192/.136
1	5045 0100	Acier inoxydable 18-8 / Stainless Steel 18-8	1.062	2	.109/.095

Rondelle plate Flat Washer

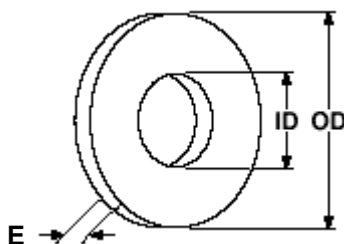

Pour boulon For Bolt	#	Matériau Material	ID	OD	E
1	5099 0100	Acier inoxydable 18-8 commercial / Commercial Stainless Steel 18-8	1.062	2-1/2	.125
1	5093 1000	Acier inoxydable 316 / Stainless Steel 316	1.062	2	.105/.095
1	0509 1000	Laiton / Brass	1-1/16	2-1/2	.144
1	0527 1000	Bronze silicieux / Silicon Bronze	1-1/16	2-1/2	.125
1	0855 0100	Acier galvanisé / Hot Dip Galvanized	1-1/16	2-1/2	.192/.136
1	0148 0100	Zingué jaune Grade 8 Yellow Zinc Plated	1-1/16	2-1/2	.146
1	0101 0100	L9	1.069/1.055	2.030/1.993	.174/.146
1	0436 0100	F436 de structure / Structural F436	1-1/8	2	.177/.136
1	0438 0100	F436 de structure zingué jaune / Structural Yellow Zinc F436	1-1/8	2	.177/.136
1	0439 0100	F436 de structure galvanisé / Structural Galvanized F436	1-1/8	2	.177/.136
	0509 1128	Laiton / Brass	1.025	1-1/2	.115
1-1/8	0144 0112	Acier nu / Plain Steel USS	1-1/4	2-3/4	.160/.138
1-1/8	0146 0112	Acier zingué / Steel Zinc Plated USS	1-1/4	2-3/4	.160/.138
1-1/8	5045 0112	Acier inoxydable 18-8 / Stainless Steel 18-8	1-3/16	2-1/2	.125
1-1/8	5093 1125	Acier inoxydable 316 / Stainless Steel 316	1-1/4	3	.125
1-1/8	0509 1125	Laiton / Brass	1-3/16	2-3/4	.156
1-1/8	0855 0112	Acier galvanisé / Hot Dip Galvanized	1-1/4	2-3/4	.160/.138
1-1/8	0101 0112	L9	1.195/1.181	2.030/.1.993	.174/.146
1-1/8	0436 0112	F436 de structure / Structural F436	1-1/4	2-1/4	.177/.136
1-1/8	0438 0112	F436 de structure zingué jaune / Structural Yellow Zinc F436	1-1/4	2-1/4	.177/.136
1-1/8	0439 0112	F436 de structure galvanisé / Structural Galvanized F436	1-1/4	2-1/4	.177/.136
1-1/8	0148 0112	Acier nu Grade 8 Plain Steel	1-1/4	2-3/4	.146
1-1/4	0144 0125	Acier nu / Plain Steel USS	1-3/8	3	.160/.136
1-1/4	0146 0125	Acier zingué / Steel Zinc Plated USS	1-3/8	3	.160/.136
1-1/4	5045 0125	Acier inoxydable 18-8 / Stainless Steel 18-8	1-3/8	3	.146
1-1/4	5093 1250	Acier inoxydable 316 / Stainless Steel 316	1-3/8	3	.146
1-1/4	0855 0125	Acier galvanisé / Hot Dip Galvanized	1-3/8	3	.160/.136
1-1/4	0101 0125	L9	1.319/1.305	2.280/2.243	.266/.234
1-1/4	0436 0125	F436 de structure / Structural F436	1-3/8	2-1/2	.177/.136
1-1/4	0438 0125	F436 de structure zingué jaune / Structural Yellow Zinc F436	1-3/8	2-1/2	.177/.136
1-1/4	0439 0125	F436 de structure galvanisé / Structural Galvanized F436	1-3/8	2-1/2	.177/.136
1-1/4	0148 0125	Acier nu Grade 8 Plain Steel	1-3/8	3	.146
1-3/8	0144 0137	Acier nu / Plain Steel USS	1-1/2	3-1/4	.187
1-3/8	0146 0137	Acier zingué / Steel Zinc Plated USS	1-1/2	3-1/4	.187
1-3/8	0436 0137	F436 de structure / Structural F436	1-1/2	2-3/4	.177/.136

Rondelle plate Flat Washer

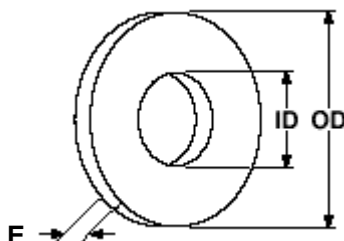

Pour boulon For Bolt	#	Matériau Material	ID	OD	E
1-3/8	0148 0137	Acier nu Grade 8 Plain Steel	1-1/2	3-1/4	.152
1-1/2	0703 0150	Acier plaqué au cadmium / Steel Cadmium Plated	1-5/8	3-1/2	.152
1-1/2	0144 0150	Acier nu / Plain Steel USS	1-5/8	3-1/2	.160/.136
1-1/2	0146 0150	Acier zingué / Steel Zinc Plated USS	1-5/8	3-1/2	.160/.136
1-1/2	5045 0150	Acier inoxydable 18-8 / Stainless Steel 18-8	1-5/8	3-1/4	.125
1-1/2	5093 1500	Acier inoxydable 316 / Stainless Steel 316	1-5/8	3-1/4	.125
1-1/2	0101 0150	L9	1.572/1.552	2.780/2.743	.266/.234
1-1/2	0436 0150	F436 de structure / Structural F436	1-5/8	3	.177/.136
1-1/2	0438 0150	F436 de structure zingué jaune / Structural Yellow Zinc F436	1-5/8	3	.177/.136
1-1/2	0439 0128	F436 de structure galvanisé / Structural Galvanized F436	1-5/8	3	.177/.136
1-1/2	0148 0150	Acier nu Grade 8 Plain Steel	1-5/8	3-1/2	.152
1-5/8	0144 0162	Acier nu / Plain Steel USS	1-5/8	3-1/4	.187
1-5/8	0146 0162	Acier zingué / Steel Zinc Plated USS	1-5/8	3-1/4	.187
1-3/4	0144 0175	Acier nu / Plain Steel USS	1-7/8	4	.187
1-3/4	0146 0175	Acier zingué / Steel Zinc Plated USS	1-7/8	4	.187
1-3/4	0436 0175	F436 de structure / Structural F436	1-7/8	3-3/8	.280/.177
1-7/8	0436 0187	F436 de structure / Structural F436	2	3-1/2	.280/.177
2	0144 0200	Acier nu / Plain Steel USS	2-1/8	4-1/2	.187
2	0146 0200	Acier zingué / Steel Zinc Plated USS	2-1/8	4-1/2	.187
2	0436 0200	F436 de structure / Structural F436	2-1/8	3-3/4	.280/.178
2-1/4	0144 0225	Acier nu / Plain Steel USS	2-3/8	5	1/4
2-1/4	0436 0225	F436 de structure / Structural F436	2-3/8	4	.340/.240
2-1/2	0144 0250	Acier nu / Plain Steel USS	2-5/8	5-1/2	3/8
2-1/2	0436 0250	F436 de structure / Structural F436	2-5/8	4-1/2	.340/.240
2-3/4	0144 0275	Acier nu / Plain Steel USS	2-7/8	6	3/8
3	0144 0300	Acier nu / Plain Steel USS	3-1/8	6-1/2	3/8

Rondelle frein Lockwasher

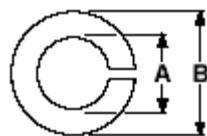

DIA		#0	#2	#3	#4	#5	#6	#8
R É G U L I È R R É G U L A R	Acier nu Plain Steel		0155 0002	0155 0003	0155 0004	0155 0005	0155 0006	0155 0008
	Zingué Zinc plated		0157 0002	0157 0003	0157 0004	0157 0005	0157 0006	0157 0008
	Zingué jaune Yellow Zinc Plated							
	Plaqué au cadmium Cadmium Plated							
	Bronze silicieux Silicon Bronze				0528 0109		0528 0140	0528 0152
	Galvanisé à chaud Hot Dip Galvanized							
	Acier inoxydable 18-8 Stainless Steel 18-8	5046 0000	5046 0002		5046 0004		5046 0006	5046 0008
	Acier inoxydable 316 Stainless Steel 316							5094 0152
	Aluminium Aluminum							
	Grade 8 acier nu Grade 8 Plain Steel							
Grade 8 zingué jaune Grade 8 Yellow Zinc Plated								
Extra fort Extra Duty	Acier nu Plain Steel							
Haut collet High collar	Acier nu Plain Steel				0159 0004	0159 0005	0159 0006	0159 0008
	Acier inox. 18-8 Stainless 18-8							
Régulier Regular	A		.094/.088	.107/.101	.120/.114	.133/.127	.148/.141	.175/.167
	B		.172	.195	.209	.236	.250	.293
	C		.020	.025	.025	.031	.031	.040
Extra fort Extra Duty	A							
	B							
	C							
Haut collet High collar	A				.120/.114		.148/.141	.174/.167
	B				.173		.216	.267
	C				.022		.030	.047

Rondelle frein Lockwasher

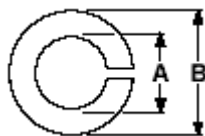

DIA		#10	#12	1/4	5/16	3/8	7/16	1/2
R É G U L I È R R E G U L A R	Acier nu Plain Steel	0155 0010	0155 0012	0155 0025	0155 0031	0155 0038	0155 0043	0155 0050
	Zingué Zinc plated	0157 0010	0157 0012	0157 0025	0157 0031	0157 0038	0157 0043	0157 0050
	Zingué jaune Yellow Zinc Plated	0626 0018						0157 0500
	Plaqué au cadmium Cadmium Plated			0172 0025	0172 0031	0172 0037	0172 0043	0172 0050
	Bronze silicieux Silicon Bronze	0528 0187		0528 0250	0528 0312	0528 0375	0528 0043	0528 0500
	Galvanisé à chaud Hot Dip Galvanized			0156 0025	0156 0031	0156 0038	0156 0043	0156 0050
	Acier inoxydable 18-8 Stainless Steel 18-8	5046 0010	5046 0012	5046 0025	5046 0031	5046 0037	5046 0043	5046 0050
	Acier inoxydable 316 Stainless Steel 316	5094 0187		5094 0250	5094 0312	5094 0375	5094 0437	5094 0500
	Aluminium Aluminum			0061 0025	0061 0031	0061 0038		0061 0050
	Grade 8 acier nu Grade 8 Plain Steel							
Grade 8 zingué jaune Grade 8 Yellow Zinc Plated			0112 0025	0112 0031	0112 0038	0112 0043	0112 0050	
Extra fort Extra Duty	Acier nu Plain Steel			0160 0025	0160 0031	0160 0038	0160 0043	0160 0050
Haut collet High collar	Acier nu Plain Steel	0159 0010		0159 0025	0159 0031	0159 0038	0159 0043	0159 0050
	Acier inox. 18-8 Stainless 18-8	5047 0010		5047 0025	5047 0031	5047 0037		5047 0050
Régulier Regular	A	.200/.193	.227/.220	.260/.252	.322/.314	.385/.377	.450/.440	.512/.502
	B	.334	.377	.487	.583	.680	.776	.869
	C	.047	.056	.062	.078	.094	.109	.125
Extra fort Extra Duty	A			.260/.252	.322/.314	.385/.377	.450/.440	.512/.502
	B			.489	.593	.688	.784	.879
	C			.077	.097	.115	.133	.151
Haut collet High collar	A	.200/.193		.260/.252	.322/.314	.385/.377		
	B	.294		.363	.457	.550		
	C	.047		.078	.093	.125		

Rondelle frein Lockwasher

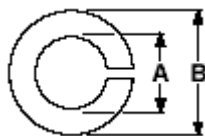

DIA		9/16	5/8	3/4	7/8	1	1-1/8	1-1/4
R É G U L I È R R E G U L A I R	Acier nu Plain Steel	0155 0056	0155 0062	0155 0075	0155 0087	0155 0100	0155 0112	0155 0125
	Zingué Zinc plated	0157 0056	0157 0062	0157 0075	0157 0087	0157 0100	0157 0112	0157 0125
	Zingué jaune Yellow Zinc Plated							
	Plaqué au cadmium Cadmium Plated		0172 0062	0172 0075	0172 0087	0172 0100	0172 0112	
	Bronze silicieux Silicon Bronze		0528 0625	0528 0750				
	Galvanisé à chaud Hot Dip Galvanized		0156 0062	0156 0075	0156 0087	0156 0100	0156 0112	0156 0125
	Acier inoxydable 18-8 Stainless Steel 18-8	5046 0056	5046 0062	5046 0075	5046 0087	5046 0100	5046 0112	5046 0125
	Acier inoxydable 316 Stainless Steel 316		5094 0625	5094 0750	5094 0875	5094 1000	5094 1125	5094 1250
	Aluminium Aluminum		0061 0062	0061 0075				
	Grade 8 acier nu Grade 8 Plain Steel						0113 0112	0113 0125
Grade 8 zingué jaune Grade 8 Yellow Zinc Plated	0112 0056	0112 0062	0112 0075	0112 0087	0112 0100			
Extra fort Extra Duty	Acier nu Plain Steel	0160 0056	0160 0062	0160 0075	0160 0087	0160 0100		
Haut collet High collar	Acier nu Plain Steel		0159 0062	0159 0075	0159 0087	0159 0100		0159 0125
	Acier inox. 18-8 Stainless 18-8		5047 0062	5047 0075				
Régulier Regular	A	.574/.564	.641/.628	.766/.753	.894/.878	1.024/1.003	1.153/1.129	1.280/1.254
	B	.965	1.073	1.265	1.459	1.656	1.847	2.036
	C	.141	.156	.188	.219	.250	.281	.312
Extra fort Extra Duty	A	.574/.564	.641/.628	.766/.753	.894/.878	1.024/1.003		1.280/1.254
	B	.975	1.087	1.285	1.489	1.700		2.104
	C	.170	.189	.226	.266	.306		.384
Haut collet High collar	A							
	B							
	C							

Rondelle frein Lockwasher

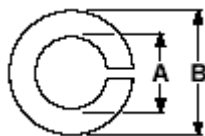

DIA		1-3/8	1-1/2	1-3/4	2	2-1/4	2-1/2	3
R É G U L I È R R E G U L A R	Acier nu Plain Steel	0155 0137	0155 0150	0155 0175	0155 0200	0155 0225	0155 0250	0155 0300
	Zingué Zinc plated	0157 0137	0157 0150	0157 0175	0157 0200			
	Zingué jaune Yellow Zinc Plated							
	Plaqué au cadmium Cadmium Plated		0172 0150	0172 0175				
	Bronze silicieux Silicon Bronze							
	Galvanisé à chaud Hot Dip Galvanized		0156 0150					
	Acier inoxydable 18-8 Stainless Steel 18-8	5046 0137	5046 0150					
	Acier inoxydable 316 Stainless Steel 316		5094 1500					
	Aluminium Aluminum							
	Grade 8 acier nu Grade 8 Plain Steel	0113 0137	0113 0150					
Grade 8 zingué jaune Grade 8 Yellow Zinc Plated								
Extra fort Extra Duty	Acier nu Plain Steel		0160 0150	0160 0175	0160 0200		0160 0250	
Haut collet High collar	Acier nu Plain Steel		0159 0150					
	Acier inox. 18-8 Stainless 18-8							
Régulier Regular	A	1.408/1.379	1.534/1.504		2.039/2.008			
	B	2.219	2.419		2.936			
	C	.344	.375		.422			
Extra fort Extra Duty	A							
	B							
	C							
Haut collet High collar	A							
	B							
	C							

Rondelle frein à dents Tooth Lockwasher

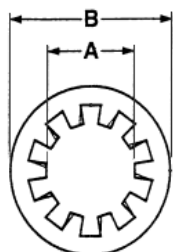

Dents internes
Internal Tooth

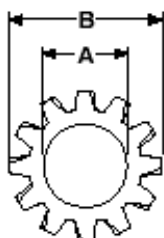

Dents externes
External Tooth

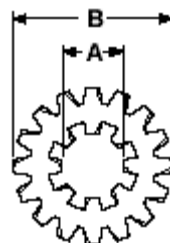

Dents internes et externes
Internal – External Tooth



DIA		#2	#4	#6	#8	#10	#12
I N T E R N A L	Acier zingué Steel Zinc Plated		0166 0004	0166 0006	0166 0008	0166 0010	0166 0012
	Bronze silicieux Silicon Bronze	0529 0078	0529 0109	0529 0140	0529 0152	0529 0187	
	Acier inoxydable 410 Stainless Steel 410	5049 0002	5049 0004	5049 0006	5049 0008	5049 0010	
E X T E R N A L	Acier zingué Steel Zinc Plated		0161 0004	0161 0006	0161 0008	0161 0010	0161 0012
	Bronze silicieux Silicon Bronze	0530 0078	0530 0109	0530 0140	0530 0152	0530 0187	
	Acier inoxydable 410 Stainless Steel 410	5050 0002	5050 0004	5050 0006	5050 0008	5050 0010	5050 0218
I N T / E X T	Acier zingué Steel Zinc Plated		0167 0004	0167 0006	0167 0008	0167 0010	0167 0012
	Bronze silicieux Silicon Bronze						
	Acier inoxydable 410 Stainless Steel 410						
Interne Internal	A	.095/.089	.123/.115	.150/.141	.176/.168	.204/.195	.231/.221
	B	.200/.175	.270/.245	.295/.275	.340/.325	.381/.365	.410/.394
	C	.015/.010	.019/.015	.021/.017	.023/.018	.025/.020	.025/.020
Externe External	A	.095/.086	.123/.115	.150/.141	.176/.168	.204/.195	.231/.221
	B	.189/.177	.260/.245	.320/.305	.381/.365	.410/.395	.475/.460
	C	.013/.010	.019/.014	.022/.016	.023/.018	.025/.020	.028/.023
Interne/Externe Internal/External	A			.150/.141	.176/.168	.204/.195	
	B			.510/.495	.610/.580	610/.580	
	C			.028/.023	.034/.028	.034/.028	

Rondelle frein à dents Tooth Lockwasher

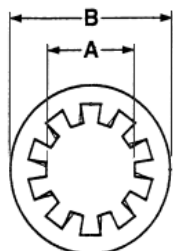

Dents internes
Internal Tooth

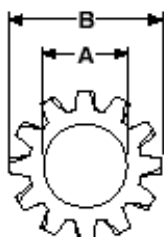

Dents externes
External Tooth

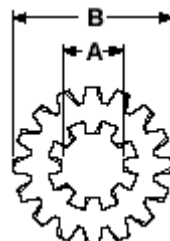

Dents internes et externes
Internal – External Tooth



DIA		1/4	5/16	3/8	7/16	1/2	9/16
I N T E R N A L	Acier zingué Steel Zinc Plated	0166 0025	0166 0031	0166 0037	0166 0043	0166 0050	0166 0056
	Bronze silicieux Silicon Bronze	0529 0250	0529 0312	0529 0375		0529 0500	
	Acier inoxydable 410 Stainless Steel 410	5049 0025	5049 0031	5049 0037	5049 0043	5049 0050	
E X T E R N A L	Acier zingué Steel Zinc Plated	0161 0025	0161 0031	0161 0037	0161 0043	0161 0050	0161 0056
	Bronze silicieux Silicon Bronze	0530 0250	0530 0312	0530 0375		0530 0500	
	Acier inoxydable 410 Stainless Steel 410	5050 0025	5050 0031	5050 0037	5050 0043	5050 0050	
I N T / E X T	Acier zingué Steel Zinc Plated	0167 0025	0167 0031	0167 0037	0167 0043	0167 0050	
	Bronze silicieux Silicon Bronze						
	Acier inoxydable 410 Stainless Steel 410						
Interne Internal	A	.267/.256	.332/.320	.398/.384	.464/.448	.530/.512	
	B	.478/.460	.610/.594	.692/.670	.789/.740	.900/.867	
	C	.028/.023	.034/.028	.040/.032	.040/.032	.045/.037	
Externe External	A	.267/.256	.332/.320	.398/.384	.464/.448	.530/.513	.596/.576
	B	.510/.494	.610/.588	.694/.670	.760/.740	.900/.880	.985/.960
	C	.028/.023	.034/.028	.040/.032	.040/.032	.045/.037	.045/.037
Interne/Externe Internal/External	A	.367/.256	.332/.320	.398/.384	.464/.448	.530/.512	
	B	.760/.725	.900/.865	.985/.965	1.070/1.045	1.260/1.220	
	C	.040/.032	.040/.032	.045/.037	.050/.042	.055/.047	

Rondelle frein à dents Tooth Lockwasher

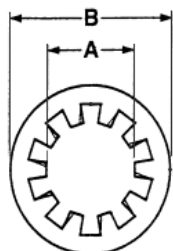

Dents internes
Internal Tooth

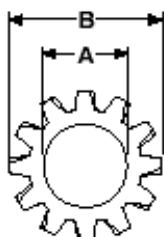

Dents externes
External Tooth

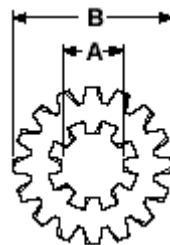

Dents internes et externes
Internal – External Tooth



DIA		5/8	3/4	7/8	1		
I N T E R N A L	Acier zingué Steel Zinc Plated	0166 0062	0166 0075	0166 0087	0166 0100		
	Bronze silicieux Silicon Bronze						
	Acier inoxydable 410 Stainless Steel 410	5049 0062	5049 0075				
E X T E R N A L	Acier zingué Steel Zinc Plated	0161 0062	0161 0075	0161 0087	0161 0100		
	Bronze silicieux Silicon Bronze						
	Acier inoxydable 410 Stainless Steel 410	5050 0062	5050 0075		5050 1000		
I N T / E X T	Acier zingué Steel Zinc Plated	0167 0062	0167 0075		0167 0100		
	Bronze silicieux Silicon Bronze						
	Acier inoxydable 410 Stainless Steel 410						
Interne Internal	A	.663/.640	.795/.769	.927/.894			
	B	1.071/1.045	1.245/1.220	1.410/1.364			
	C	.050/.042	.055/.047	.060/.052			
Externe External	A	.663/.641	.795/.768	.927/.897	1.060/1.025		
	B	1.070/1.045	1.260/1.220	1.410/1.380	1.620/1.590		
	C	.050/.042	.055/.047	.060/.052	.067/.059		
Interne/Externe Internal/External	A	.663/.640					
	B	1.410/1.380					
	C	.060/.052					

Rondelle conique à denture externe Countersunk External Tooth Lockwasher

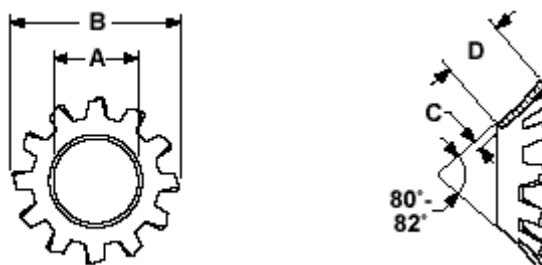

DIA	#4	#6	#8	#10	#12
Acier zingué Steel Zinc Plated	0169 0004	0169 0006	0169 0008	0169 0010	0169 0012
Acier inoxydable 410 Stainless Steel 410					
A	.123/.113	.150/.140	.177/.167	.205/.195	.231/.220
B	.213	.289	.322	.354	.421
C	.019/.015	.021/.017	.021/.017	.025/.020	.025/.020
D	.065/.050	.092/.082	.0105/.088	.099/.083	.128/.118

DIA	1/4	5/16	3/8	1/2	
Acier zingué Steel Zinc Plated	0169 0025	0169 0031	0169 0038	0169 0050	
Acier inoxydable 410 Stainless Steel 410	0491 0250				
A	.267/.255	.333/.318	.398/.383	.529/.512	
B	.454	.599	.765	.996	
C	.025/.020	.028/.023	.034/.028	.045/.037	
D	.128/.113	.192/.165	.255/.242	.304/.294	

Rondelle de finition Countersunk Finishing Washer

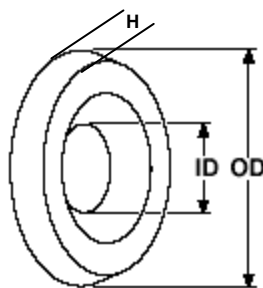

DIA	#4	#6	#8	#10	#12
Acier nickelé Steel Nickel Plated	0171 0004	0171 0006	0171 0008	0171 0010	0171 0012
Acier inoxydable 18-8 Stainless Steel 18-8		5048 0006	5048 0008	5048 0010	5048 0012
Laiton Brass		0510 0140	0510 0152	0510 0187	0510 0218
ID	.150/.120	.200/.170	.210/.180	.265/.235	.289/.259
OD	3/8	15/32	17/32	19/32	21/32
H	3/32	5/64	7/64	7/64	1/8

DIA	1/4(#14)	5/16	3/8	7/16	1/2
Acier nickelé Steel Nickel Plated	0171 0025	0171 0031			
Acier inoxydable 18-8 Stainless Steel 18-8	5048 0025				
Laiton Brass	0510 0250				
ID	.335/.305				
OD	25/32				
H	5/32				

Rondelle Disc-Lock®

Disc-Lock® Washer

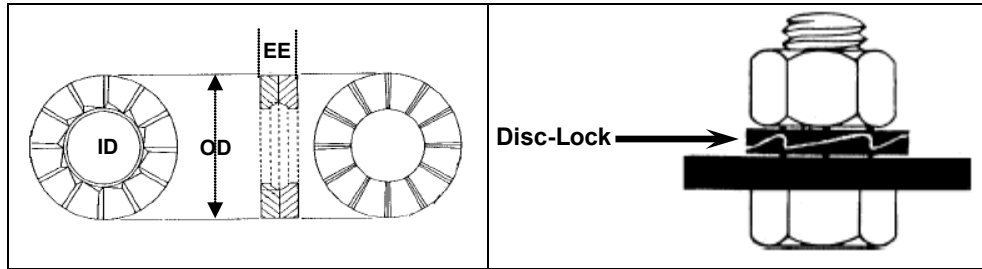

VENDES ET FACTURÉES À LA PAIRE / SOLD AND BILLED BY PAIR						
Pour boulon de For both size		Acier durci zingué Hardened Steel Zinc Plated	Acier inoxydable Stainless Steel 316 (A4)	ID	OD	EE
Po/In	mm					
#6	3	00G9 0006		.150	.340	.080
#8	4	00G9 0008		.175	.340	.080
3/16	5	00G9 0010		.203	.401	.080
1/4	6	00G9 0025		.262	.495	.101
5/16	8	00G9 0031		.326	.628	.119
3/8	10	00G9 0001		.409	.705	.135
7/16	11	00G9 0043		.450	.880	.135
1/2	12	00G9 0050		.510	.937	.136
9/16	14	00G9 0056		.572	1.128	.127
5/8	16	00G9 0062		.651	1.247	.134
3/4	20	00G9 0002		.820	1.381	.183
7/8	22	00G9 0087		.883	1.470	.240
1	25	00G9 0003		1.015	1.626	.240
1-1/16	27			1.079	1.650	.135
1-1/8	28	00G9 0112		1.140	1.715	.240
1-1/4	32	00G9 0005		1.275	1.875	.264
1-3/8	36	00G9 0137		1.430	2.196	.230
1-1/2	38	00G9 0150		1.523	2.196	.230

Rondelle Nord-Lock® (paire)

Nord-Lock® Washer (pair)

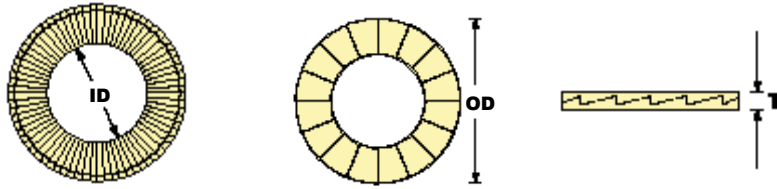

DIA	Acier zingué jaune Yellow Zinc Plated	Acier inoxydable 18-8 Stainless Steel	Acier inoxydable 316 Stainless Steel	ID	OD	T zingué jaune Yellow Zinc	T inoxydable Stainless
#5				0.13	0.28	0.07	0.09
#6				0.15	0.29	0.07	0.09
#6				0.15	0.35	0.07	0.09
#8				0.17	0.29	0.07	0.09
#8				0.17	0.35	0.07	0.09
#10				0.21	0.35	0.07	0.09
#10				0.21	0.43	0.07	0.09
1/4				0.28	0.45	0.07	0.09
1/4				0.28	0.53	0.10	0.09
5/16				0.34	0.53	0.10	0.09
5/16				0.34	0.65	0.10	0.09
3/8				0.41	Z 0.65 SS 0.63	0.10	0.09
3/8				0.41	0.83	0.10	0.09
7/16				0.45	0.73	0.10	0.09
1/2				0.53	0.77	0.10	0.09
1/2				0.53	1.00	0.13	0.13
9/16				0.60	0.91	0.13	0.13
9/16				0.60	1.21	0.13	0.13
5/8				0.67	1.00	0.13	0.13
5/8				0.67	1.21	0.13	0.13
3/4				0.79	1.21	0.13	0.13
3/4				0.79	1.54	0.13	0.13
7/8				0.92	1.36	0.13	0.13
7/8				0.92	1.65	0.18	0.13

Rondelle Nord-Lock® (paire) Nord-Lock® Washer (pair)

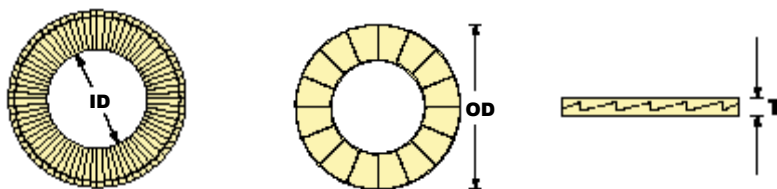

DIA	Acier zingué jaune Yellow Zinc Plated	Acier inoxydable 18-8 Stainless Steel	Acier inoxydable 316 Stainless Steel	ID	OD	T zingué jaune Yellow Zinc	T inoxydable Stainless
1				1.10	1.54	0.13	0.13
1				1.10	1.91	0.18	0.13
1-1/8				1.24	1.85	0.26	0.27
1-1/8				1.24	2.30	0.26	0.27
1-1/4				1.35	1.91	0.26	0.27
1-3/8				1.47	2.17	0.26	0.27
1-1/2				1.59	2.30	0.26	0.27
1-3/4				1.82	2.76	0.37	0.35
2				2.11	3.15	0.37	0.35
2-1/4				2.33	3.35	0.37	0.35
2-1/2				2.64	3.74	0.37	0.35
3				3.11	4.33	0.37	0.35

Rondelle Belleville Belleville Washer

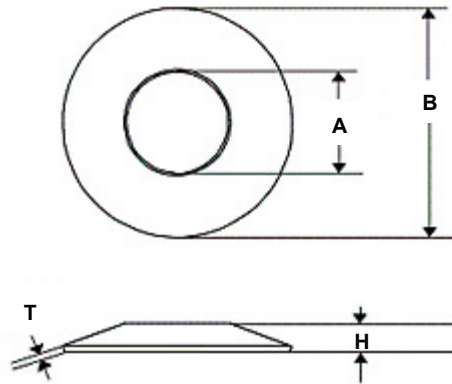

**Disponible - en dimensions impériales et métriques
en acier nu durci et en acier inoxydable
en épaisseur standard et pour ouvrage lourd**

**Available - In Imperial And Metric Sizes
In Hardened Steel And Stainless Steel
With Standard And Heavy Duty Thickness**

Rondelle d'obturation Sealing Washer

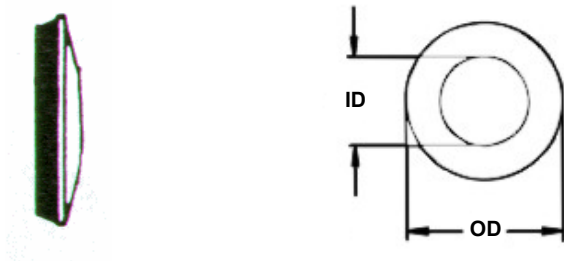

DIA	Acier galvanisé Galvanized Steel	Acier inoxydable Stainless Steel	ID	OD	GA
#6		0482 0006	5/32	3/8	20
#8	0170 0156	0482 0008	11/64	1/2	20
#10	0170 0187	0482 0010	13/64	1/2	20
#12	0170 0200	0482 0012	7/32	5/8	20
#14	0170 0250	0482 0025	.275	5/8	20
5/16	0170 0312	0482 0031	.330	3/4	20
3/8	0170 0375	0482 0038	.434	7/8	20
1/2			.532	1	20

Rondelle O.G. O.G. Washer



DIA	Acier moulé Cast Iron	ID	OD	Épaisseur Thick
1/2		2	5/8	1/2
5/8		2-3/4	3/4	5/8
3/4	0746 0075	3	7/8	3/4
7/8		3-1/2	1	7/8
1	0746 0100	4	1-1/8	1
1-1/8		4-1/4	1-1/4	1-1/8
1-1/4		4-1/2	1-3/8	1-1/4
1-1/2		5-1/4	1-5/8	1-1/2

Plaquette oblique Bevel Washer

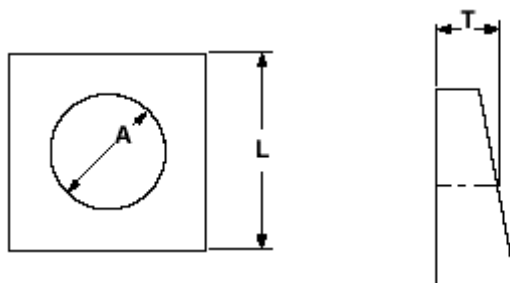

DIA	Fonte malléable Malleable Iron	Fonte galvanisée M.I. Galvanized	Fonte zinguée M.I. Zinc Plated	F436	A	L	T
3/8	0163 0038	0164 0038	0580 0037	0437 0037	.437	1.250	.187
1/2	0163 0050	0164 0050	0580 0050	0437 0050	.531	1.250	.313
5/8	0163 0062	0164 0062	0580 0062	0437 0062	.688	1.500	.313
3/4	0163 0075	0164 0075	0580 0075	0437 0075	.813	1.500	.313
7/8	0163 0087	0164 0088	0580 0087	0437 0087	.938	2.000	.313
1	0163 0100	0164 0100	0580 0100	0437 0100	1.125	2.000	.313
1-1/8					1.250	2.250	.313
1-1/4					1.375	2.250	.313
1-3/8					1.500	2.250	.313
1-1/2					1.625	2.250	.313

Joint torique O-Ring Seal

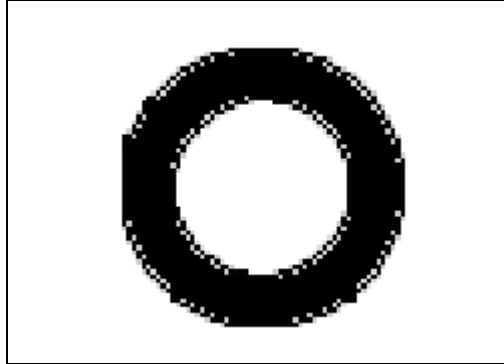

**DISPONIBLE EN PLUSIEURS DIMENSIONS
AVAILABLE IN MANY SIZES**

Rondelle plate régulière

Regular Flat Washer

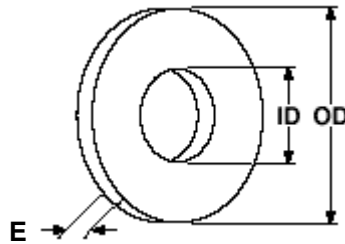

Pour boulon Bolt Size	Acier nu Plain Steel	Acier zingué Zinc Plated	Acier galvanisé à chaud Hot Dip Galvanized	Acier inoxydable Stainless Steel		ID	OD	E
				A2 (18-8)	A4 (316)			
M1				7333 0001		1.1	3.2	0.3
M1.2				7333 0011		1.3	3.8	0.3
M1.4				7333 0013		1.5	3.8	0.3
M1.6	9638 0015	9639 0015		7333 0015		1.7	4.0	0.3
M1.7	9638 0017	9639 0017		7333 0017		1.8	4.5	0.3
M2	9638 0002	9639 0002		7333 0002	7334 0002	2.2	5.0	0.3
M2.3		9639 0023		7333 0023		2.5	6.0	0.5
M2.5	9638 0025	9639 0025		7333 0025	7334 0025	2.7	6.0	0.5
M2.6	9638 0026	9639 0026		7333 0026		2.8	7.0	0.5
M3	9638 0003	9639 0003		7333 0003	7334 0003	3.2	7.0	0.5
M3.5	9638 0035	9639 0035		7333 0035	7334 0035	3.7	8.0	0.5
M4	9638 0004	9639 0004		7333 0004	7334 0004	4.3	9.0	0.8
M5	9638 0005	9639 0005		7333 0005	7334 0005	5.3	10.0	1.0
M6	9638 0006	9639 0006	0608 0006	7333 0006	7334 0006	6.4	12.0	1.6
M7	9638 0007	9639 0007				7.4	14.0	1.6
M8	9638 0008	9639 0008	0608 0008	7333 0008	7334 0008	8.4	16.0	1.6
M10	9638 0010	9639 0010	0608 0010	7333 0010	7334 0010	10.5	20.0	2.0
M12	9638 0012	9639 0012	0608 0012	7333 0012	7334 0012	13.0	24.0	2.5
M14	9638 0014	9639 0014		7333 0014	7334 0014	15.0	28.0	2.5
M16	9638 0016	9639 0016	0608 0016	7333 0016	7334 0016	17.0	30.0	3.0
M18	9638 0018	9639 0018		7333 0018	7334 0018	19.0	34.0	3.0
M20	9638 0020	9639 0020	0608 0020	7333 0020	7334 0020	21.0	37.0	3.0
M22	9638 0022	9639 0022		7333 0022	7334 0022	23.0	39.0	3.0
M24	9638 0024	9639 0024	0608 0024	7333 0024	7334 0024	25.0	44.0	4.0
M27	9638 0027	9639 0027	0608 0027	7333 0027	7334 0027	28.0	50.0	4.0
M30	9638 0030	9639 0030	0608 0030	7333 0030	7334 0030	31.0	56.0	4.0
M33	9638 0033	9639 0033		7333 0033	7334 0033	34.0	60.0	5.0
M36	9638 0036	9639 0036	0608 0036	7333 0036	7334 0036	37.0	66.0	5.0
M39	9638 0039	9639 0039				40.0	72.0	6.0
M42	9638 0042	9639 0042				43.0	78.0	7.0
M45	9638 0045	9639 0045				46.0	85.0	7.0
M48	9638 0048	9639 0048	0608 0048			50.0	92.0	8.0
M52	9638 0052	9639 0052				54.0	98.0	8.0
M56	9638 0056	9639 0056				58.0	105.0	9.0

Rondelle plate Flat Washer

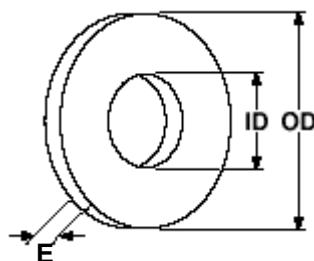

Pour boulon Bolt Size	Acier nu Plain Steel	Acier zingué Zinc Plated	Acier galvanisé à chaud Hot Dip Galvanized	Acier inoxydable Stainless Steel		ID	OD	E
				A2 (18-8)	A4 (316)			
RONDELLE PARE-CHOC / FENDER WASHER						DIN 9021A		
M2.5		0607 0025				2.7	8.0	0.8
M3		0607 0003				3.2	9.0	0.8
M3.5		0607 0035				3.7	11.0	0.8
M4		0607 0004				4.3	12.0	1.0
M5		0607 0005				5.3	15.0	1.6
M6		0607 0006				6.4	18.0	1.6
M7		0607 0007				7.4	22.0	2.0
M8		0607 0008				8.4	24.0	2.0
M10		0607 0010				10.5	30.0	2.5
M10		0607 1050				10.5	50.0	2.5
M12		0607 0012				13.0	37.0	3.0
M14		0607 0014				15.0	44.0	3.0
M16		0607 0016				17.0	50.0	3.0
M18		0607 0018				20.0	56.0	4.0
M20		0607 0020				22.0	60.0	4.0
RONDELLE PARE-CHOC / FENDER WASHER						DIN 9021B		
M6				9926 0006		6.4	18.0	1.6
RONDELLE PLATE ÉPAISSE / THICK FLAT WASHER						DIN 7349		
M6		0609 0006				6.4	17.0	3.0
M8		0609 0008				8.4	21.0	4.0
M10		0609 0010				10.5	25.0	4.0
M12		0609 0012				13.0	30.0	6.0
RONDELLE À STRUCTURE / STRUCTURAL FLAT WASHER						DIN 6916-10		
M12	9640 0012					13.0	24.0	3.0
M16	9640 0016					17.0	30.0	4.0
M18	9640 0018					19.0	34.0	4.0
M20	9640 0020					21.0	37.0	4.0
M22	9640 0022					23.0	39.0	4.0
M24	9640 0024					25.0	44.0	4.0
M27	9640 0027					28.0	50.0	5.0
M30	9640 0030					31.0	56.0	5.0
M33	9640 0033					34.0	60.0	5.0
M36	9640 0036					37.0	66.0	6.0

Rondelle plate Flat Washer

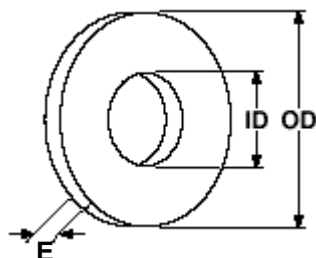

Pour boulon Bolt Size	Acier nu Plain Steel	Acier zingué Zinc Plated	Acier galvanisé à chaud Hot Dip Galvanized	Acier inoxydable Stainless Steel		ID	OD	E
				A2 (18-8)	A4 (316)			
RONDELLE PLATE AVEC PETIT OD / SMALL OD FLAT WASHER						DIN 433		
M1		0688 0001				1.1	2.5	0.3
M1.2		0688 0120				1.3	3.0	0.3
M1.4		0688 0140				1.5	3.0	0.3
M1.6		0688 0160				1.7	3.5	0.3
M1.8		0688 0180				1.9	4.0	0.3
M2		0688 0002				2.2	4.5	0.3
M2.5		0688 0250				2.7	5.0	0.5
M3		0688 0003				3.2	6.0	0.5
M3.5		0688 0350				3.7	7.0	0.5
M4		0688 0004				4.3	8.0	0.5
M5		0688 0005				5.3	9.0	1.0
M6		0688 0006				6.4	11.0	1.6
M8		0688 0008				8.4	15.0	1.6
M10		0688 0010				10.5	18.0	1.6
M12		0688 0012				13.0	20.0	2.0
M14		0688 0014				15.0	24.0	2.5
M16		0688 0016				17.0	27.0	2.0
M18		0688 0018				19.0	30.0	3.0
M20		0688 0020				21.0	34.0	3.0

Rondelle frein régulière

Regular Lockwasher

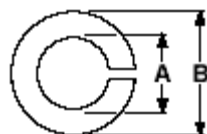

Pour boulon Bolt Size	Acier nu Plain Steel	Acier zingué Zinc Plated	Acier inoxydable Stainless Steel		A	B	C
			A2 (18-8)	A4 (316)			
M2	9641 0002	9642 0002	7335 0002	7336 0002	2.1	4.4	0.5
M2.3	9641 0023	9642 0023	7335 0023		2.4	4.9	0.6
M2.5	9641 0025	9642 0025	7335 0025	7336 0025	2.6	5.1	0.6
M2.6	9641 0260		7335 0026		2.7	5.2	0.6
M3	9641 0003	9642 0003	7335 0003	7336 0003	3.1	6.2	0.8
M3.5	9641 0034	9642 0034	7335 0035		3.6	6.7	0.8
M4	9641 0004	9642 0004	7335 0004	7336 0004	4.1	7.6	0.9
M5	9641 0005	9642 0005	7335 0005	7336 0005	5.1	9.2	1.2
M6	9641 0006	9642 0006	7335 0006	7336 0006	6.1	11.8	1.6
M6.4	9641 0064	9642 0064			6.5	11.4	1.6
M7	9641 0007	9642 0007	7335 0007		7.1	12.8	1.6
M8	9641 0008	9642 0008	7335 0008	7336 0008	8.1	14.8	2.0
M10	9641 0010	9642 0010	7335 0010	7336 0010	10.2	18.1	2.2
M11	9641 0011	9642 0011			11.4	18.3	2.1
M12	9641 0012	9642 0012	7335 0012	7336 0012	12.2	21.1	2.5
M13	9641 0013	9642 0013			13.4	21.2	2.4
M14	9641 0014	9642 0014	7335 0014	7336 0014	14.2	24.1	3.0
M16	9641 0016	9642 0016	7335 0016	7336 0016	16.2	27.4	3.5
M18	9641 0018	9642 0018	7335 0018	7336 0018	18.2	29.4	3.5
M20	9641 0020	9642 0020	7335 0020	7336 0020	20.2	33.6	4.0
M22	9641 0022	9642 0022	7335 0022	7336 0022	22.5	35.9	4.0
M24	9641 0024	9642 0024	7335 0024	7336 0024	24.5	40.0	5.0
M26		9642 0026			26.6	40.3	5.0
M27	9641 0027	9642 0027	7335 0027	7336 0027	27.5	43.0	5.0
M28	9641 0028	9642 0028			28.4	42.4	5.0
M30	9641 0030	9642 0030	7335 0030	7336 0030	30.5	48.2	6.0
M32	9641 0032	9642 0032			33.0	48.8	6.0
M33	9641 0033	9642 0033			33.5	55.2	6.0
M35	9641 0035	9642 0035			36.0	55.8	6.0
M36	9641 0036	9642 0036		7336 0036	36.5	58.2	6.0
M39	9641 0039				39.5	61.2	6.0
M42	9641 0042				42.5	68.2	7.0
M45	9641 0045				45.5	71.2	7.0
M48	9641 0048				49.0	75.0	7.0
M52	9641 0052				53.0	83.0	8.0

Rondelle frein à haut collet High Collar Lockwasher

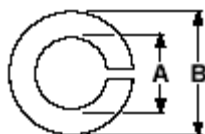

Pour boulon Bolt Size	Acier nu Plain Steel	Acier zingué Zinc Plated	Acier inoxydable Stainless Steel		A	B	C
			A2 (18-8)	A4 (316)			
M3	9652 0003		7337 0003	7338 0003	3.1	5.6	1.0
M3.5	9652 0035						
M4	9652 0004		7337 0004	7338 0004	4.1	7.0	1.2
M5	9652 0005		7337 0005	7338 0005	5.1	8.8	1.6
M6	9652 0006		7337 0006	7338 0006	6.1	9.9	1.6
M8	9652 0008		7337 0008	7338 0008	8.1	12.7	2.0
M10	9652 0010		7337 0010	7338 0010	10.2	16.0	2.5
M12	9652 0012		7337 0012	7338 0012	12.2	18.0	2.5
M14	9652 0014				14.2	21.1	3.0
M16	9652 0016		7337 0016	7338 0016	16.2	24.4	3.5
M18	9652 0018						
M20	9652 0020		7337 0020	7338 0020	20.2	30.6	4.5
M22	9652 0022						
M24	9652 0024			7338 0024	24.5	35.9	5.0
M27	9652 0027						
M30	9652 0030						
M33	9652 0033						
M36	9652 0036						
M39	9652 0039						
M42	9652 0042						
M48	9652 0048						

Rondelle frein à dents Tooth Lockwasher

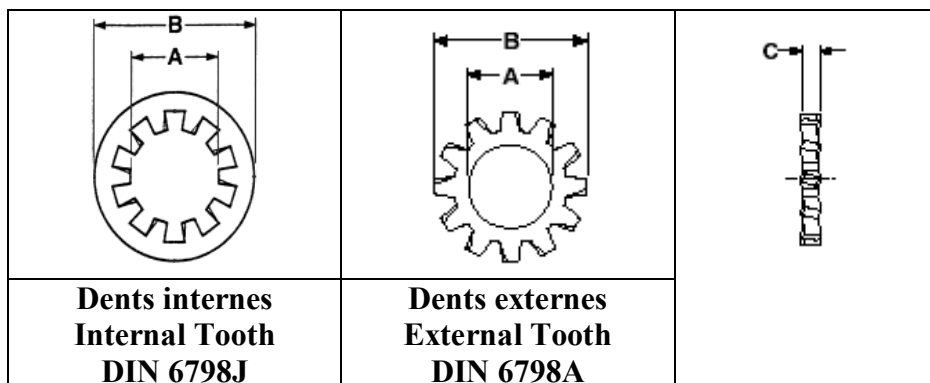

**Dents internes
Internal Tooth
DIN 6798J**

**Dents externes
External Tooth
DIN 6798A**

Pour boulon Bolt Size	Acier zingué Steel Zinc Plated	Acier inoxydable Stainless Steel A2 (18-8)	Acier zingué Steel Zinc Plated	Acier inoxydable Stainless Steel A2 (18-8)	A	B	C
M2	9644 0002	7340 0002	9643 0002	7339 0002	2.2	4.5	0.3
M2.5	9644 0025	7340 0025	9643 0025	7339 0025	2.7	5.5	0.4
M2.6	9644 0026				2.8	5.5	0.4
M3	9644 0003	7340 0003	9643 0003	7339 0003	3.2	6.0	0.4
M3.5	9644 0035		9643 0035	7339 0035	3.7	7.0	0.5
M4	9644 0004	7340 0004	9643 0004	7339 0004	4.3	8.0	0.5
M5	9644 0005	7340 0005	9643 0005	7339 0005	5.3	10.0	0.6
M6	9644 0006	7340 0006	9643 0006	7339 0006	6.4	11.0	0.7
M6.3	9644 0063		9643 0063		6.5	12.3	0.7
M7	9644 0007		9643 0007		7.4	12.5	0.8
M8	9644 0008	7340 0008	9643 0008	7339 0008	8.4	15.0	0.8
M10	9644 0010	7340 0010	9643 0010	7339 0010	10.5	18.0	0.9
M12	9644 0012	7340 0012	9643 0012	7339 0012	12.5	20.5	1.0
M14	9644 0014	7340 0014	9643 0014	7339 0014	14.5	24.0	1.0
M16	9644 0016	7340 0016	9643 0016*	7339 0016	16.5	26.0	1.2
M18	9644 0018		9643 0018		19.0	30.0	1.4
M20	9644 0020	7340 0020	9643 0020	7339 0020	21.0	33.0	1.4
M22	9644 0022		9643 0022		23.0	36.0	1.5
M24	9644 0024	7340 0024	9643 0024	7339 0024	25.0	38.0	1.5
M27	9644 0027		9643 0027		28.0	44.0	1.6
M30	9644 0030		9643 0030		31.0	48.0	1.6

* Zinc